

Miniature Ball Bearings



Miniature bearings are sometimes referred to as instrument bearings and are used in applications as varied as gyros, anemometers, flow meters, miniature gearboxes, small motors and radio controlled models. Miniature ball bearings can be open or shielded, which helps prevent dirt from entering and lubricant from leaking out, and unflanged or flanged for easier plate mounting. Some miniature ball bearing options feature extended inner rings to help fit certain locking devices when a press fit is not possible.



Table of Contents

Section 1

Inch Standard.....	3
--------------------	---

Section 2

Inch Flanged.....	5
-------------------	---

Section 3

Inch With Extended Inner Ring.	7
-------------------------------------	---

Section 4

Inch Flanged With Extended Inner Ring.....	8
--	---

Section 5

Metric Standard.....	9
----------------------	---

Section 6

Metric Flanged.....	16
---------------------	----

Section 7

Metric Thrust.....	22
--------------------	----



Section 1 *Inch Standard*

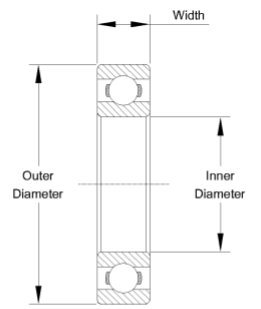

Standard Bearing (Open Type)

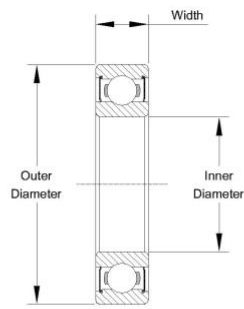

Sealed Bearing (Rubber Seal)

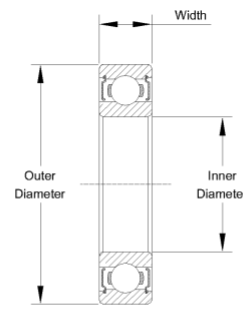

Sealed Bearing (Metal Shielded)

Part Number	Seal Type	Bore Dia	Outer Dia	Width	Dynamic Radial Load	Static Radial Load	Max Speed (X1000 rpm)
R09	Open	0.04"	0.125"	0.0469"	20.020 lbf	5.006 lbf	130
R0	Open	0.04688"	0.15625"	0.0625"	21.022 lbf	6.008 lbf	110
R0zz	Shielded	0.04688"	0.15625"	0.0937"	21.022 lbf	6.008 lbf	110
R1	Open	0.05556"	0.1875"	0.0781"	44.046 lbf	12.013 lbf	90
R1zz	Shielded	0.05556"	0.1875"	0.1094"	44.046 lbf	12.013 lbf	90
R1-4	Open	0.07813"	0.25"	0.0937"	54.058 lbf	17.019 lbf	67
R1-4 2rs	Sealed	0.07813"	0.25"	0.1406"	54.058 lbf	17.019 lbf	67
R1-4zz	Shielded	0.07813"	0.25"	0.1406"	54.058 lbf	17.019 lbf	67
R1-5	Open	0.09375"	0.3125"	0.1094"	106.114 lbf	32.033 lbf	60
R1-5 2rs	Sealed	0.09375"	0.3125"	0.1406"	106.114 lbf	32.033 lbf	60
R1-5zz	Shielded	0.09375"	0.3125"	0.1406"	106.114 lbf	32.033 lbf	60
R133	Open	0.09375"	0.1875"	0.0625"	36.038 lbf	11.012 lbf	80
R133zz	Shielded	0.09375"	0.1875"	0.0937"	28.030 lbf	10.010 lbf	80
R133 2rs	Sealed	0.09375"	0.1875"	0.0937"	28.030 lbf	10.010 lbf	80
R144	Open	0.125"	0.25"	0.0937"	54.058 lbf	17.019 lbf	67
R144 2rs	Sealed	0.125"	0.25"	0.1094"	54.058 lbf	17.019 lbf	67
R144zz	Shielded	0.125"	0.25"	0.1094"	54.058 lbf	17.019 lbf	67
R2	Open	0.125"	0.375"	0.1562"	121.129 lbf	39.042 lbf	56
R2 2rs	Sealed	0.125"	0.375"	0.1562"	121.129 lbf	39.042 lbf	56
R2zz	Shielded	0.125"	0.375"	0.1562"	121.129 lbf	39.042 lbf	56
R2-5	Open	0.125"	0.3125"	0.1094"	107.114 lbf	32.033 lbf	60
R2-5 2rs	Sealed	0.125"	0.3125"	0.1406"	107.114 lbf	32.033 lbf	60
R2-5zz	Shielded	0.125"	0.3125"	0.1406"	107.114 lbf	32.033 lbf	60
R2-6	Open	0.125"	0.375"	0.1094"	122.130 lbf	41.044 lbf	53
R2-6 2rs	Sealed	0.125"	0.375"	0.1406"	122.130 lbf	41.044 lbf	53
R2-6zz	Shielded	0.125"	0.375"	0.1406"	122.130 lbf	41.044 lbf	53
R2Azz	Shielded	0.125"	0.5"	0.1719"	122.130 lbf	41.044 lbf	53
R2A	Open	0.125"	0.5"	0.1719"	122.130 lbf	41.044 lbf	53
R2A 2rs	Sealed	0.125"	0.5"	0.1719"	122.130 lbf	41.044 lbf	53
R155	Open	0.15625"	0.3125"	0.1094"	69.073 lbf	27.029 lbf	53
R155zz	Shielded	0.15625"	0.3125"	0.1250"	69.073 lbf	27.029 lbf	53

* We produce stainless steel miniature bearings, please send RFQ or talk to sales representatives.



Section 1 *Inch Standard*

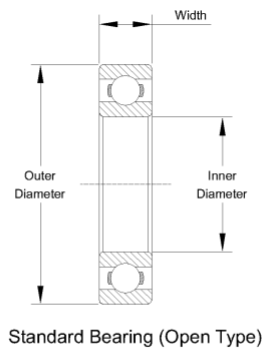

Standard Bearing (Open Type)

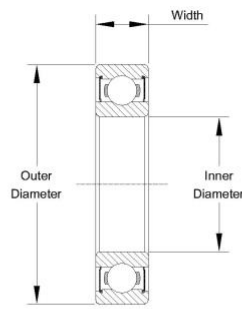

Sealed Bearing (Rubber Seal)

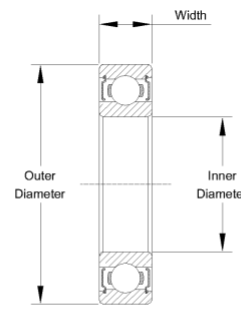

Sealed Bearing (Metal Shielded)

Part Number	Seal Type	Bore Dia	Outer Dia	Width	Dynamic Radial Load	Static Radial Load	Max Speed (X1000 rpm)
R155 2rs	Sealed	0.15625"	0.3125"	0.1250"	69.073 lbf	27.029 lbf	53
R156	Open	0.1875"	0.3125"	0.1094"	69.073 lbf	27.029 lbf	53
R156 2rs	Sealed	0.1875"	0.3125"	0.1250"	69.073 lbf	27.029 lbf	53
R166	Open	0.1875"	0.375"	0.1250"	136.145 lbf	49.052 lbf	50
R166 2rs	Sealed	0.1875"	0.375"	0.1250"	136.145 lbf	49.052 lbf	50
R156zz	Shielded	0.1875"	0.3125"	0.1250"	69.073 lbf	27.029 lbf	53
R166zz	Shielded	0.1875"	0.375"	0.1250"	136.145 lbf	49.052 lbf	50
R3	Open	0.1875"	0.5"	0.1562"	249.266 lbf	88.094 lbf	43
R3 2rs	Sealed	0.1875"	0.5"	0.1960"	249.266 lbf	88.094 lbf	43
R3A 2rs	Open	0.1875"	0.625"	0.1960"	333.284 lbf	131.112 lbf	38
R3Azz	Shielded	0.1875"	0.625"	0.1960"	283.302 lbf	112.120 lbf	38
R3zz	Shielded	0.1875"	0.5"	0.1960"	249.266 lbf	88.094 lbf	43
R3A	Open	0.1875"	0.625"	0.1960"	283.302 lbf	112.120 lbf	38
R168	Open	0.25"	0.375"	0.1250"	71.075 lbf	31.034 lbf	48
R168 2rs	Sealed	0.25"	0.375"	0.1250"	71.075 lbf	31.034 lbf	48
R168zz	Shielded	0.25"	0.375"	0.1250"	71.075 lbf	31.034 lbf	48
R188	Open	0.25"	0.5"	0.1250"	207.220 lbf	80.086 lbf	40
R188 2rs	Sealed	0.25"	0.5"	0.1875"	207.220 lbf	80.086 lbf	40
R188zz	Shielded	0.25"	0.5"	0.1875"	207.220 lbf	80.086 lbf	40
R4	Open	0.25"	0.625"	0.1960"	283.302 lbf	112.120 lbf	38
R4 2rs	Sealed	0.25"	0.625"	0.1960"	283.302 lbf	112.120 lbf	38
R4zz	Shielded	0.25"	0.625"	0.1960"	283.302 lbf	112.120 lbf	38
R4A	Open	0.25"	0.75"	0.2188"	446.476 lbf	161.172 lbf	36
R4A 2rs	Sealed	0.25"	0.75"	0.2812"	446.476 lbf	161.172 lbf	36
R4Azz	Shielded	0.25"	0.75"	0.2812"	446.476 lbf	161.172 lbf	36
R1810	Open	0.3125"	0.5"	0.1562"	104.112 lbf	50.054 lbf	40
R1810 2rs	Sealed	0.3125"	0.5"	0.1562"	104.112 lbf	50.054 lbf	40
R1810zz	Shielded	0.3125"	0.5"	0.1562"	104.112 lbf	50.054 lbf	40
R6	Open	0.375"	0.875"	0.2188"	637.682 lbf	256.275 lbf	32
R6 2rs	Sealed	0.375"	0.875"	0.2812"	637.682 lbf	256.275 lbf	32
R6zz	Shielded	0.375"	0.875"	0.2812"	637.682 lbf	256.275 lbf	32



Section 2 Inch Flanged

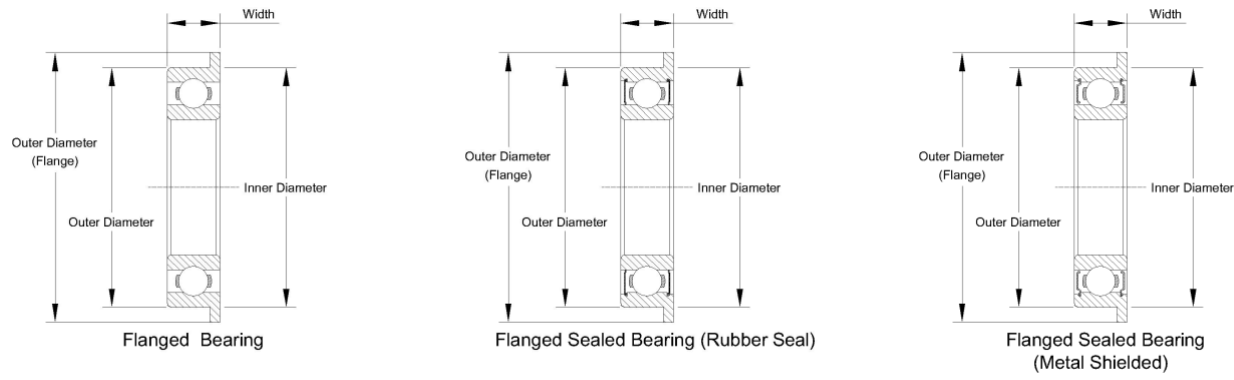

Part Number	Seal Type	Bore Dia	Outer Dia	Width	Flange Outer Dia	Flange Thickness	Dynamic Radial Load	Static Radial Load	Max Speed (X1000 rpm)
FR0	Open	0.04688"	0.15625"	0.0625"	0.2030"	0.013"	21.022 lbf	6.008 lbf	110
FR0zz	Shielded	0.04688"	0.15625"	0.0937"	0.2030"	0.031"	21.022 lbf	6.008 lbf	110
FR1	Open	0.05556"	0.1875"	0.0781"	0.2340"	0.023"	44.046 lbf	12.013 lbf	90
FR1zz	Shielded	0.05556"	0.1875"	0.1094"	0.2340"	0.031"	44.046 lbf	12.013 lbf	90
FR1-4	Open	0.07813"	0.25"	0.0937"	0.2960"	0.023"	54.058 lbf	17.019 lbf	67
FR1-4 2rs	Sealed	0.07813"	0.25"	0.1406"	0.2960"	0.031"	54.058 lbf	17.019 lbf	67
FR1-4zz	Shielded	0.07813"	0.25"	0.1406"	0.2960"	0.031"	54.058 lbf	17.019 lbf	67
FR1-5	Open	0.09375"	0.3125"	0.1094"	0.3590"	0.023"	106.114 lbf	32.033 lbf	60
FR1-5 2rs	Sealed	0.09375"	0.3125"	0.1406"	0.3590"	0.031"	106.114 lbf	32.033 lbf	60
FR1-5zz	Shielded	0.09375"	0.3125"	0.1406"	0.3590"	0.031"	106.114 lbf	32.033 lbf	60
FR133	Open	0.09375"	0.1875"	0.0625"	0.2340"	0.018"	36.038 lbf	11.012 lbf	80
FR133 2rs	Sealed	0.09375"	0.1875"	0.0937"	0.2340"	0.031"	28.030 lbf	10.010 lbf	80
FR133zz	Shielded	0.09375"	0.1875"	0.0937"	0.2340"	0.031"	28.030 lbf	10.010 lbf	80
FR144	Open	0.125"	0.25"	0.0937"	0.2960"	0.023"	54.058 lbf	17.019 lbf	67
FR144 2rs	Sealed	0.125"	0.25"	0.1094"	0.2960"	0.031"	54.058 lbf	17.019 lbf	67
FR144zz	Shielded	0.125"	0.25"	0.1094"	0.2960"	0.031"	54.058 lbf	17.019 lbf	67
FR2	Open	0.125"	0.375"	0.1562"	0.4400"	0.030"	121.129 lbf	39.042 lbf	56
FR2 2rs	Sealed	0.125"	0.375"	0.1562"	0.4400"	0.030"	121.129 lbf	39.042 lbf	56
FR2zz	Shielded	0.125"	0.375"	0.1562"	0.4400"	0.030"	121.129 lbf	39.042 lbf	56
FR2-5	Open	0.125"	0.3125"	0.1094"	0.3590"	0.023"	107.114 lbf	32.033 lbf	60
FR2-5 2rs	Sealed	0.125"	0.3125"	0.1406"	0.3590"	0.031"	107.114 lbf	32.033 lbf	60
FR2-5zz	Shielded	0.125"	0.3125"	0.1406"	0.3590"	0.031"	107.114 lbf	32.033 lbf	60
FR2-6	Open	0.125"	0.375"	0.1094"	0.4220"	0.023"	122.130 lbf	41.044 lbf	53
FR2-6 2rs	Sealed	0.125"	0.375"	0.1406"	0.4220"	0.031"	122.130 lbf	41.044 lbf	53
FR2-6zz	Shielded	0.125"	0.375"	0.1406"	0.4220"	0.031"	122.130 lbf	41.044 lbf	53
FR155	Open	0.15625"	0.3125"	0.1094"	0.3590"	0.023"	69.073 lbf	27.029 lbf	53
FR155 2rs	Sealed	0.15625"	0.3125"	0.1250"	0.3590"	0.036"	69.073 lbf	27.029 lbf	53
FR155zz	Shielded	0.15625"	0.3125"	0.1250"	0.3590"	0.036"	69.073 lbf	27.029 lbf	53
FR156	Open	0.1875"	0.3125"	0.1094"	0.3590"	0.023"	69.073 lbf	27.029 lbf	53
FR156 2rs	Sealed	0.1875"	0.3125"	0.1250"	0.3590"	0.036"	69.073 lbf	27.029 lbf	53

* We produce stainless steel miniature bearings, please send RFQ or talk to sales representatives.



Section 2 Inch Flanged

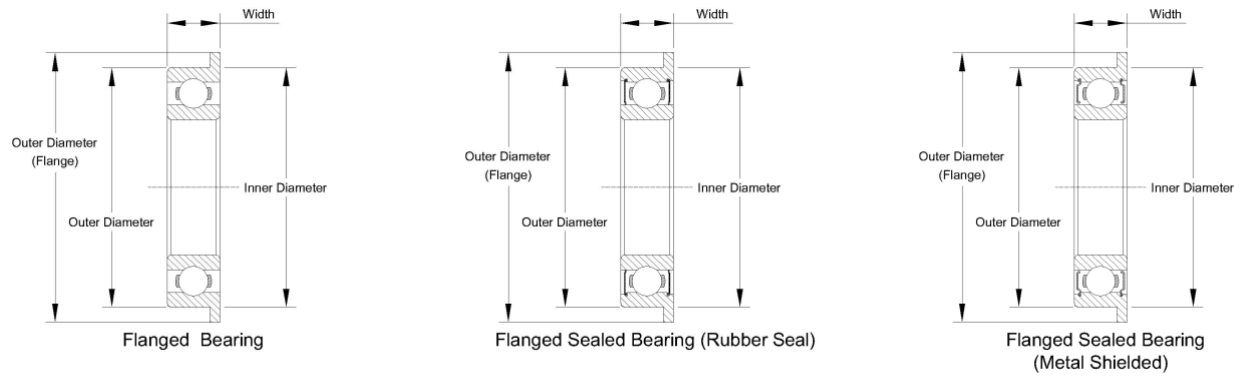

Part Number	Seal Type	Bore Dia	Outer Dia	Width	Flange Outer Dia	Flange Thickness	Dynamic Radial Load	Static Radial Load	Max Speed (X1000 rpm)
FR156zz	Shielded	0.1875"	0.3125"	0.1250"	0.3590"	0.036"	69.073 lbf	27.029 lbf	53
FR166	Open	0.1875"	0.375"	0.1250"	0.4220"	0.023"	136.145 lbf	49.052 lbf	50
FR166 2rs	Sealed	0.1875"	0.375"	0.1250"	0.4220"	0.031"	136.145 lbf	49.052 lbf	50
FR166zz	Shielded	0.1875"	0.375"	0.1250"	0.4220"	0.031"	136.145 lbf	49.052 lbf	50
FR3	Open	0.1875"	0.5"	0.1906"	0.5650"	0.042"	249.266 lbf	88.094 lbf	43
FR3 2rs	Sealed	0.1875"	0.5"	0.1906"	0.5650"	0.042"	249.266 lbf	88.094 lbf	43
FR3zz	Shielded	0.1875"	0.5"	0.1960"	0.5650"	0.042"	249.266 lbf	88.094 lbf	43
FR168	Open	0.25"	0.375"	0.1250"	0.4220"	0.023"	71.075 lbf	31.034 lbf	48
FR168 2rs	Sealed	0.25"	0.375"	0.1250"	0.4220"	0.036"	71.075 lbf	31.034 lbf	48
FR168zz	Shielded	0.25"	0.375"	0.1250"	0.4220"	0.036"	71.075 lbf	31.034 lbf	48
FR188	Open	0.25"	0.5"	0.1250"	0.5470"	0.023"	344.367 lbf	80.086 lbf	40
FR188 2rs	Sealed	0.25"	0.5"	0.1875"	0.5470"	0.045"	344.367 lbf	80.086 lbf	40
FR188zz	Shielded	0.25"	0.5"	0.1875"	0.5470"	0.045"	344.367 lbf	80.086 lbf	40
FR4	Open	0.25"	0.625"	0.1960"	0.6900"	0.042"	283.302 lbf	112.120 lbf	38
FR4 2rs	Sealed	0.25"	0.625"	0.1960"	0.6900"	0.042"	283.302 lbf	112.120 lbf	38
FR4zz	Shielded	0.25"	0.625"	0.1960"	0.6900"	0.042"	283.302 lbf	112.120 lbf	38
FR1810	Open	0.3125"	0.5"	0.1562"	0.5470"	0.031"	104.112 lbf	50.054 lbf	40
FR1810 2rs	Sealed	0.3125"	0.5"	0.1562"	0.5470"	0.031"	104.112 lbf	50.054 lbf	40
FR1810zz	Shielded	0.3125"	0.5"	0.1562"	0.5470"	0.031"	104.112 lbf	50.054 lbf	40
FR6	Open	0.375"	0.875"	0.2188"	0.9650"	0.062"	637.682 lbf	256.275 lbf	32
FR6 2rs	Sealed	0.375"	0.875"	0.2812"	0.9650"	0.062"	637.682 lbf	256.275 lbf	32
FR6zz	Shielded	0.375"	0.875"	0.2812"	0.9650"	0.062"	637.682 lbf	256.275 lbf	32



Section 3 Inch With Extended Inner Ring

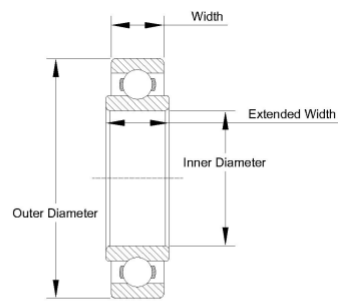

Bearing With Extended Inner Ring

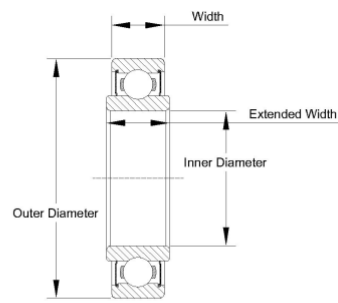

Sealed Bearing With Extended Inner Ring (Rubber Seal)

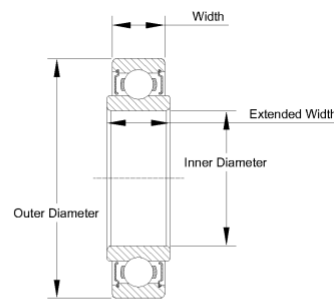

Sealed Bearing With Extended Inner Ring (Metal Shielded)

Part Number	Seal Type	Bore Dia	Outer Dia	Width	Inner Ring Outer Dia	Inner Ring Width	Dynamic Radial Load	Static Radial Load	Max Speed (X1000 rpm)
RW0zz	Shielded	0.04688"	0.15625"	0.0937"	0.081"	0.1249"	21.022 lbf	6.008 lbf	110
RW0	Open	0.04688"	0.15625"	0.0625"	0.081"	0.0937"	21.022 lbf	6.008 lbf	110
RW1zz	Shielded	0.05556"	0.1875"	0.1094"	0.093"	0.1406"	44.046 lbf	12.013 lbf	90
RW1	Open	0.05556"	0.1875"	0.0781"	0.093"	0.1094"	44.046 lbf	12.013 lbf	90
RW1-4zz	Shielded	0.07813"	0.25"	0.1406"	0.122"	0.1719"	54.058 lbf	17.019 lbf	67
RW1-4	Open	0.07813"	0.25"	0.0937"	0.122"	0.125"	54.058 lbf	17.019 lbf	67
RW133zz	Shielded	0.09375"	0.1875"	0.0937"	0.118"	0.125 "	28.030 lbf	10.010 lbf	80
RW1-5zz	Shielded	0.09375"	0.3125"	0.1406"	0.173"	0.1719"	106.114 lbf	32.033 lbf	60
RW133	Open	0.09375"	0.1875"	0.0625"	0.118"	0.0937"	28.030 lbf	10.010 lbf	80
RW1-5	Open	0.09375"	0.3125"	0.1094"	0.173"	0.1406"	106.114 lbf	32.033 lbf	60
RW144zz	Shielded	0.125"	0.25"	0.1094"	0.161"	0.1406"	54.058 lbf	17.019 lbf	67
RW2-5zz	Shielded	0.125"	0.3125"	0.1406"	0.173"	0.1719"	107.114 lbf	32.033 lbf	60
RW2-6zz	Shielded	0.125"	0.375"	0.1406"	0.173"	0.1719"	122.130 lbf	41.044 lbf	53
RW2zz	Shielded	0.125"	0.375"	0.1562"	0.2"	0.1875"	121.129 lbf	39.042 lbf	56
RW144	Open	0.125"	0.25"	0.0937"	0.161"	0.125"	54.058 lbf	17.019 lbf	67
RW2-5	Open	0.125"	0.3125"	0.1094"	0.173"	0.1406"	107.114 lbf	32.033 lbf	60
RW2-6	Open	0.125"	0.375"	0.1094"	0.173"	0.1406"	122.130 lbf	41.044 lbf	53
RW2	Open	0.125"	0.375"	0.1562"	0.2"	0.1875"	121.129 lbf	39.042 lbf	56
RW155zz	Shielded	0.15625"	0.3125"	0.125"	0.221"	0.1562"	69.073 lbf	27.029 lbf	53
RW155	Open	0.15625"	0.3125"	0.1094"	0.221"	0.1406"	69.073 lbf	27.029 lbf	53
RW156zz	Shielded	0.1875"	0.3125"	0.125"	0.221"	0.1562"	69.073 lbf	27.029 lbf	53
RW166zz	Shielded	0.1875"	0.375"	0.125"	0.235"	0.1562"	136.145 lbf	49.052 lbf	50
RW3zz	Shielded	0.1875"	0.5"	0.196"	0.276"	0.2273"	249.266 lbf	88.094 lbf	43
RW156	Open	0.1875"	0.3125"	0.1094"	0.221"	0.1406"	69.073 lbf	27.029 lbf	53
RW166	Open	0.1875"	0.375"	0.125"	0.235"	0.1562"	136.145 lbf	49.052 lbf	50
RW3	Open	0.1875"	0.5"	0.1562"	0.276"	0.1875"	249.266 lbf	88.094 lbf	43
RW168zz	Shielded	0.25"	0.375"	0.125"	0.285"	0.1562"	71.075 lbf	31.034 lbf	48
RW188zz	Shielded	0.25"	0.5"	0.1875"	0.33"	0.2188"	207.220 lbf	80.086 lbf	40
RW4zz	Shielded	0.25"	0.625"	0.196"	0.364"	0.2273"	283.302 lbf	112.120 lbf	38
RW168	Open	0.25"	0.375"	0.125"	0.285"	0.1562"	71.075 lbf	31.034 lbf	48
RW188	Open	0.25"	0.5"	0.125"	0.33"	0.1562"	207.220 lbf	80.086 lbf	40
RW4	Open	0.25"	0.625"	0.196"	0.364"	0.2273"	283.302 lbf	112.120 lbf	38
RW1810zz	Shielded	0.3125"	0.5"	0.1562"	0.362"	0.1875"	104.112 lbf	50.054 lbf	40
RW1810	Open	0.3125"	0.5"	0.1562"	0.362"	0.1875"	104.112 lbf	50.054 lbf	40



Section 4 *Inch Flanged With Extended Inner Ring*

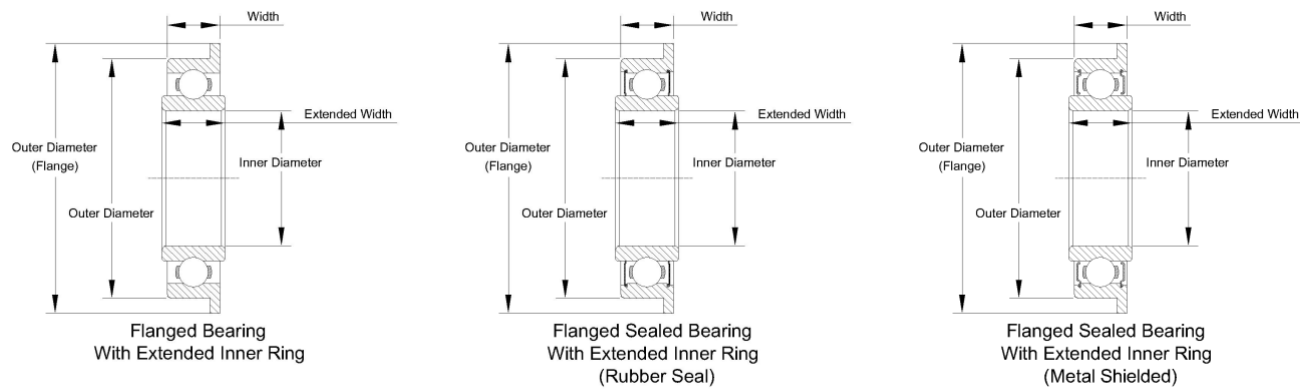

Part Number	Seal Type	Bore Dia	Outer Dia	Width	Flange Outer Dia	Flange Thickness	Inner Ring Outer Dia	Inner Ring Width	Dynamic Radial Load	Static Radial Load	Max Speed (X1000 rpm)
FRW0zz	Shielded	0.04688"	0.15625"	0.0937"	0.203"	0.031"	0.081"	0.1249"	21.022 lbf	6.008 lbf	110
FRW0	Open	0.04688"	0.15625"	0.0625"	0.203"	0.013"	0.081"	0.0937"	21.022 lbf	6.008 lbf	110
FRW1zz	Shielded	0.05556"	0.1875"	0.1094"	0.234"	0.031"	0.093"	0.1406"	44.046 lbf	12.013 lbf	90
FRW1	Open	0.05556"	0.1875"	0.0781"	0.234"	0.023"	0.093"	0.1094"	44.046 lbf	12.013 lbf	90
FRW1-4zz	Shielded	0.07813"	0.25"	0.1406"	0.296"	0.031"	0.122"	0.1719"	54.058 lbf	17.019 lbf	110
FRW1-4	Open	0.07813"	0.25"	0.0937"	0.296"	0.023"	0.122"	0.125"	54.058 lbf	17.019 lbf	110
FRW133zz	Shielded	0.09375"	0.1875"	0.0937"	0.234"	0.031"	0.118"	0.125"	28.030 lbf	10.010 lbf	80
FRW1-5zz	Shielded	0.09375"	0.3125"	0.1406"	0.359"	0.031"	0.173"	0.1719"	106.114 lbf	32.033 lbf	110
FRW133	Open	0.09375"	0.1875"	0.0625"	0.234"	0.018"	0.118"	0.0937"	28.030 lbf	10.010 lbf	80
FRW1-5	Open	0.09375"	0.3125"	0.1094"	0.359"	0.023"	0.173"	0.1406"	106.114 lbf	32.033 lbf	110
FRW144zz	Shielded	0.125"	0.25"	0.1094"	0.296"	0.031"	0.161"	0.1406"	54.058 lbf	17.019 lbf	67
FRW2-6zz	Shielded	0.125"	0.375"	0.1406"	0.422"	0.031"	0.173"	0.1719"	122.130 lbf	41.044 lbf	53
FRW2-5zz	Shielded	0.125"	0.3125"	0.1406"	0.359"	0.031"	0.173"	0.1719"	107.114 lbf	32.033 lbf	110
FRW2zz	Shielded	0.125"	0.375"	0.1562"	0.44"	0.03"	0.2"	0.1875"	121.129 lbf	39.042 lbf	110
FRW144	Open	0.125"	0.25"	0.0937"	0.296"	0.023"	0.161"	0.125"	54.058 lbf	17.019 lbf	67
FRW2-5	Open	0.125"	0.3125"	0.1094"	0.359"	0.023"	0.173"	0.1406"	107.114 lbf	32.033 lbf	110
FRW2-6	Open	0.125"	0.375"	0.1094"	0.422"	0.023"	0.173"	0.1406"	122.130 lbf	41.044 lbf	53
FRW2	Open	0.125"	0.375"	0.1562"	0.44"	0.03"	0.2"	0.1875"	121.129 lbf	39.042 lbf	110
FRW155zz	Shielded	0.15625"	0.3125"	0.125"	0.359"	0.036"	0.221"	0.1562"	69.073 lbf	27.029 lbf	53
FRW155	Open	0.15625"	0.3125"	0.1094"	0.359"	0.023"	0.221"	0.1406"	69.073 lbf	27.029 lbf	53
FRW3zz	Shielded	0.1875"	0.5"	0.196"	0.565"	0.042"	0.221"	0.2273"	249.266 lbf	88.094 lbf	110
FRW166zz	Shielded	0.1875"	0.375"	0.125"	0.422"	0.031"	0.235"	0.1562"	136.145 lbf	49.052 lbf	50
FRW156zz	Shielded	0.1875"	0.3125"	0.125"	0.359"	0.036"	0.276"	0.1562"	69.073 lbf	27.029 lbf	110
FRW156	Open	0.1875"	0.3125"	0.1094"	0.359"	0.023"	0.221"	0.1406"	69.073 lbf	27.029 lbf	110
FRW166	Open	0.1875"	0.375"	0.125"	0.422"	0.023"	0.235"	0.1562"	136.145 lbf	49.052 lbf	50
FRW3	Open	0.1875"	0.5"	0.1562"	0.565"	0.042"	0.276"	0.1875"	249.266 lbf	88.094 lbf	110
FRW3 W19	Open	0.1875"	0.5"	0.2273"	0.565"	0.042"	0.285"	0.2273"	249.266 lbf	88.094 lbf	43
FRW188zz	Shielded	0.25"	0.5"	0.1875"	0.422"	0.035"	0.33"	0.2188"	344.367 lbf	80.086 lbf	48
FRW4zz	Shielded	0.25"	0.625"	0.196"	0.69"	0.042"	0.364"	0.2273"	283.302 lbf	112.120 lbf	110
FRW168zz	Shielded	0.25"	0.375"	0.125"	0.422"	0.035"	0.285"	0.1562"	71.075 lbf	31.034 lbf	48
FRW168	Open	0.25"	0.375"	0.125"	0.422"	0.023"	0.33"	0.1562"	71.075 lbf	31.034 lbf	48
FRW188	Open	0.25"	0.5"	0.125"	0.422"	0.023"	0.364"	0.1562"	344.367 lbf	80.086 lbf	48
FRW4	Open	0.25"	0.625"	0.196"	0.69"	0.042"	0.362"	0.2273"	283.302 lbf	112.120 lbf	110
FRW1810zz	Shielded	0.3125"	0.5"	0.1562"	0.547"	0.031"	0.362"	0.1875"	104.112 lbf	50.054 lbf	40



Section 5 *Metric Standard*

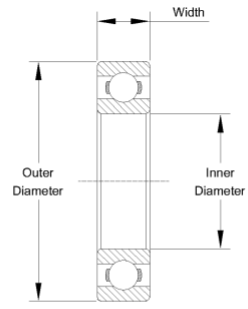

Standard Bearing (Open Type)

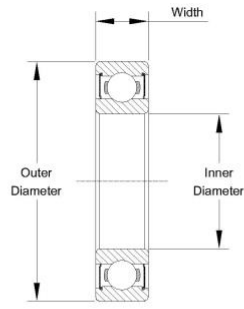

Sealed Bearing (Rubber Seal)

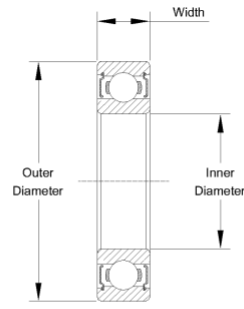

Sealed Bearing (Metal Shielded)

Part Number	Seal Type	Bore Dia	Outer Dia	Width	Dynamic Radial Load	Static Radial Load	Max Speed (X1000 rpm)
68/0.6	Open	0.6 mm	2.5 mm	1 mm	59.000 N	14.000 N	128
681	Open	1 mm	3 mm	1 mm	82.000 N	21.000 N	130
MR31	Open	1 mm	3 mm	1.5 mm	96.000 N	25.000 N	117
691	Open	1 mm	4 mm	1.6 mm	120.000 N	30.000 N	100
MR41x	Open	1.2 mm	4 mm	1.8 mm	112.000 N	33.000 N	105
MR41xzz	Shielded	1.2 mm	4 mm	2.5 mm	112.000 N	33.000 N	105
681x	Open	1.5 mm	4 mm	1.2 mm	95.000 N	26.000 N	100
681xzz	Shielded	1.5 mm	4 mm	2 mm	95.000 N	26.000 N	100
691x	Open	1.5 mm	5 mm	2 mm	144.000 N	40.000 N	85
691xzz	Shielded	1.5 mm	5 mm	2.6 mm	144.000 N	40.000 N	85
601x	Open	1.5 mm	6 mm	2.5 mm	281.000 N	79.000 N	75
601xzz	Shielded	1.5 mm	6 mm	3 mm	281.000 N	79.000 N	75
682	Open	2 mm	5 mm	1.5 mm	144.000 N	40.000 N	85
682zz	Shielded	2 mm	5 mm	2.3 mm	144.000 N	40.000 N	85
MR52	Open	2 mm	5 mm	2 mm	144.000 N	40.000 N	85
MR52zz	Shielded	2 mm	5 mm	2.5 mm	144.000 N	40.000 N	85
692 2rs	Sealed	2 mm	6 mm	3 mm	281.000 N	79.000 N	75
692zz	Shielded	2 mm	6 mm	3 mm	281.000 N	79.000 N	75
692	Open	2 mm	6 mm	2.3 mm	281.000 N	79.000 N	75
MR62	Open	2 mm	6 mm	2.5 mm	281.000 N	79.000 N	75
MR62zz	Shielded	2 mm	6 mm	2.5 mm	281.000 N	79.000 N	75
MR72	Open	2 mm	7 mm	2.5 mm	328.000 N	103.000 N	63
MR72 2rs	Sealed	2 mm	7 mm	3 mm	328.000 N	103.000 N	63
MR72zz	Shielded	2 mm	7 mm	3 mm	328.000 N	103.000 N	65
602	Open	2 mm	7 mm	2.8 mm	328.000 N	103.000 N	60
602zz	Shielded	2 mm	7 mm	3.5 mm	328.000 N	103.000 N	60
602 2rs	Sealed	2 mm	7 mm	3.5 mm	328.000 N	103.000 N	60
682 2rs	Sealed	2 mm	5 mm	2.3 mm	144.000 N	40.000 N	85
MR52 2rs	Sealed	2 mm	5 mm	2.5 mm	144.000 N	40.000 N	85
MR62 2rs	Sealed	2 mm	6 mm	2.5 mm	281.000 N	79.000 N	75
672	Open	2 mm	4 mm	1.2 mm	124.000 N	40.000 N	98
672zz	Shielded	2 mm	4 mm	2 mm	124.000 N	40.000 N	98
682x	Open	2.5 mm	6 mm	1.8 mm	178.000 N	59.000 N	71

* We produce stainless steel miniature bearings, please send RFQ or talk to sales representatives.

Section 5 Metric Standard

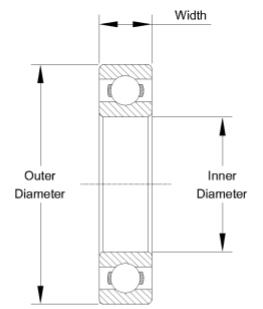

Standard Bearing (Open Type)

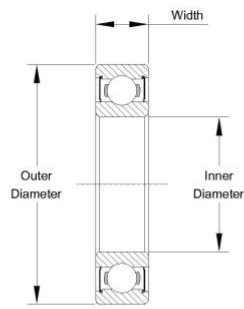

Sealed Bearing (Rubber Seal)

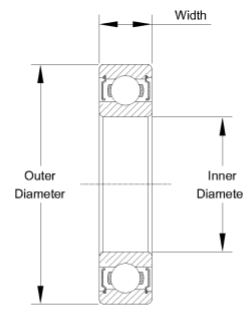

Sealed Bearing (Metal Shielded)

Part Number	Seal Type	Bore Dia	Outer Dia	Width	Dynamic Radial Load	Static Radial Load	Max Speed (X1000 rpm)
682xzz	Shielded	2.5 mm	6 mm	2.6 mm	178.000 N	59.000 N	71
692x	Open	2.5 mm	7 mm	2.5 mm	328.000 N	103.000 N	63
692x 2rs	Sealed	2.5 mm	7 mm	3.5 mm	328.000 N	103.000 N	63
692xzz	Shielded	2.5 mm	7 mm	3.5 mm	328.000 N	103.000 N	63
MR82x	Open	2.5 mm	8 mm	2.5 mm	474.000 N	144.000 N	60
602x	Open	2.5 mm	8 mm	2.8 mm	469.000 N	142.000 N	60
602xzz	Shielded	2.5 mm	8 mm	4 mm	469.000 N	142.000 N	60
682x 2rs	Sealed	2.5 mm	6 mm	2.6 mm	178.000 N	59.000 N	71
MR82x 2rs	Sealed	2.5 mm	8 mm	2.5 mm	474.000 N	144.000 N	60
MR82xzz	Shielded	2.5 mm	8 mm	2.5 mm	474.000 N	144.000 N	60
602x 2rs	Sealed	2.5 mm	8 mm	4 mm	469.000 N	142.000 N	60
MR63	Open	3 mm	6 mm	2 mm	178.000 N	59.000 N	71
MR63zz	Shielded	3 mm	6 mm	2.5 mm	178.000 N	59.000 N	71
683	Open	3 mm	7 mm	2 mm	264.000 N	90.000 N	63
683 2rs	Sealed	3 mm	7 mm	3 mm	264.000 N	90.000 N	63
683zz	Shielded	3 mm	7 mm	3 mm	264.000 N	90.000 N	63
MR83	Open	3 mm	8 mm	2.5 mm	336.000 N	113.000 N	60
MR83zz	Shielded	3 mm	8 mm	3 mm	336.000 N	113.000 N	60
693	Open	3 mm	8 mm	3 mm	474.000 N	144.000 N	60
693 2rs	Sealed	3 mm	8 mm	4 mm	474.000 N	144.000 N	60
693zz	Shielded	3 mm	8 mm	4 mm	474.000 N	144.000 N	60
MR93	Open	3 mm	9 mm	2.5 mm	485.000 N	151.000 N	56
MR93zz	Shielded	3 mm	9 mm	4 mm	485.000 N	151.000 N	56
603	Open	3 mm	9 mm	3 mm	230.000 N	151.000 N	56
603zz	Shielded	3 mm	9 mm	5 mm	230.000 N	151.000 N	56
623	Open	3 mm	10 mm	4 mm	536.000 N	175.000 N	50
623 2rs	Sealed	3 mm	10 mm	4 mm	536.000 N	175.000 N	50
623zz	Shielded	3 mm	10 mm	4 mm	536.000 N	175.000 N	50
633	Open	3 mm	13 mm	5 mm	1106.000 N	390.000 N	40
633 2rs	Sealed	3 mm	13 mm	5 mm	1106.000 N	390.000 N	40
633zz	Shielded	3 mm	13 mm	5 mm	1106.000 N	390.000 N	40
MR63 2rs	Sealed	3 mm	6 mm	2.5 mm	178.000 N	59.000 N	71
MR83 2rs	Sealed	3 mm	8 mm	3 mm	336.000 N	113.000 N	60
MR93 2rs	Sealed	3 mm	9 mm	4 mm	485.000 N	151.000 N	56
603 2rs	Sealed	3 mm	9 mm	5 mm	230.000 N	151.000 N	56

Section 5 Metric Standard

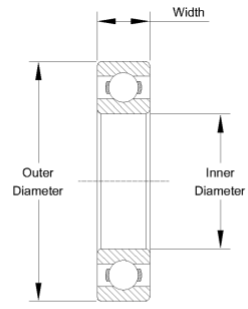

Standard Bearing (Open Type)

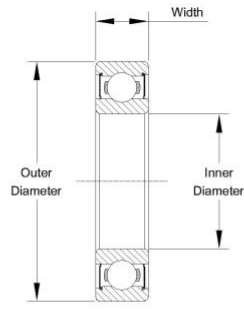

Sealed Bearing (Rubber Seal)

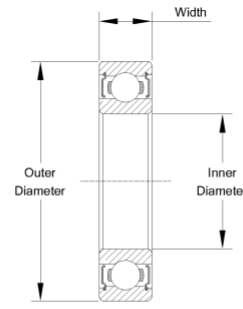

Sealed Bearing (Metal Shielded)

Part Number	Seal Type	Bore Dia	Outer Dia	Width	Dynamic Radial Load	Static Radial Load	Max Speed (X1000 rpm)
MR74	Open	4 mm	7 mm	2 mm	264.000 N	92.000 N	60
MR74zz	Shielded	4 mm	7 mm	2.5 mm	217.000 N	86.000 N	60
MR84	Open	4 mm	8 mm	2 mm	336.000 N	113.000 N	56
684	Open	4 mm	9 mm	2.5 mm	545.000 N	182.000 N	53
684 2rs	Sealed	4 mm	9 mm	4 mm	545.000 N	182.000 N	53
684zz	Shielded	4 mm	9 mm	4 mm	545.000 N	182.000 N	53
MR84zz	Shielded	4 mm	8 mm	3 mm	336.000 N	113.000 N	56
MR104	Open	4 mm	10 mm	3 mm	604.000 N	218.000 N	48
MR104zz	Shielded	4 mm	10 mm	4 mm	604.000 N	218.000 N	48
694	Open	4 mm	11 mm	4 mm	814.000 N	280.000 N	48
694 2rs	Sealed	4 mm	11 mm	4 mm	814.000 N	280.000 N	48
MR104 2rs	Sealed	4 mm	10 mm	4 mm	604.000 N	218.000 N	48
694zz	Shielded	4 mm	11 mm	4 mm	814.000 N	280.000 N	48
604	Open	4 mm	12 mm	4 mm	814.000 N	280.000 N	48
604 2rs	Sealed	4 mm	12 mm	4 mm	814.000 N	280.000 N	48
604zz	Shielded	4 mm	12 mm	4 mm	814.000 N	280.000 N	48
624	Open	4 mm	13 mm	5 mm	1106.000 N	390.000 N	40
624 2rs	Sealed	4 mm	13 mm	5 mm	1106.000 N	390.000 N	40
624zz	Shielded	4 mm	13 mm	5 mm	1106.000 N	390.000 N	40
634	Open	4 mm	16 mm	5 mm	1139.000 N	418.000 N	36
634 2rs	Sealed	4 mm	16 mm	5 mm	1139.000 N	418.000 N	36
634zz	Shielded	4 mm	16 mm	5 mm	1139.000 N	418.000 N	36
MR74 2rs	Sealed	4 mm	7 mm	2.5 mm	217.000 N	86.000 N	60
MR84 2rs	Sealed	4 mm	8 mm	3 mm	336.000 N	113.000 N	56
605zz	Shielded	5 mm	14 mm	5 mm	1130.000 N	406.000 N	40
MR85	Open	5 mm	8 mm	2 mm	262.000 N	96.000 N	53
MR85 2rs	Sealed	5 mm	8 mm	2.5 mm	185.000 N	72.000 N	53
MR85zz	Shielded	5 mm	8 mm	2.5 mm	185.000 N	72.000 N	53
MR95 2rs	Sealed	5 mm	9 mm	3 mm	366.000 N	135.000 N	50
MR115zz	Shielded	5 mm	11 mm	4 mm	609.000 N	226.000 N	45
605 2rs	Sealed	5 mm	14 mm	5 mm	1130.000 N	406.000 N	40

Section 5 Metric Standard

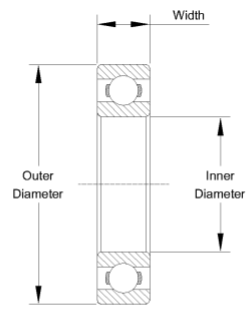

Standard Bearing (Open Type)

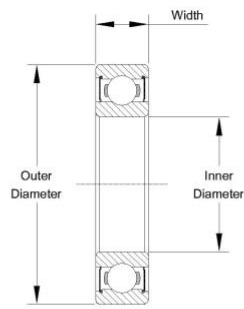

Sealed Bearing (Rubber Seal)

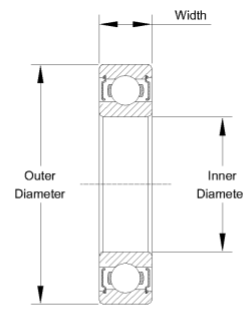

Sealed Bearing (Metal Shielded)

Part Number	Seal Type	Bore Dia	Outer Dia	Width	Dynamic Radial Load	Static Radial Load	Max Speed (X1000 rpm)
695 2rs	Sealed	5 mm	13 mm	4 mm	916.000 N	346.000 N	43
MR105zz	Shielded	5 mm	10 mm	4 mm	366.000 N	135.000 N	50
635	Open	5 mm	19 mm	6 mm	1986.000 N	717.000 N	32
MR105	Open	5 mm	10 mm	3 mm	366.000 N	135.000 N	50
695zz	Shielded	5 mm	13 mm	4 mm	916.000 N	346.000 N	43
605	Open	5 mm	14 mm	5 mm	1130.000 N	406.000 N	40
625	Open	5 mm	16 mm	5 mm	1470.000 N	540.000 N	36
625 2rs	Sealed	5 mm	16 mm	5 mm	1470.000 N	540.000 N	36
625zz	Shielded	5 mm	16 mm	5 mm	1470.000 N	540.000 N	36
635 2rs	Sealed	5 mm	19 mm	6 mm	1986.000 N	717.000 N	32
635zz	Shielded	5 mm	19 mm	6 mm	1986.000 N	717.000 N	32
695	Open	5 mm	13 mm	4 mm	916.000 N	346.000 N	43
685 2rs	Sealed	5 mm	11 mm	5 mm	609.000 N	226.000 N	45
685zz	Shielded	5 mm	11 mm	5 mm	609.000 N	226.000 N	45
MR105 2rs	Sealed	5 mm	10 mm	4 mm	366.000 N	135.000 N	50
MR95zz	Shielded	5 mm	9 mm	3 mm	366.000 N	135.000 N	50
MR95	Open	5 mm	9 mm	2.5 mm	366.000 N	135.000 N	50
685	Open	5 mm	11 mm	3 mm	609.000 N	226.000 N	45
MR115 2rs	Sealed	5 mm	11 mm	4 mm	609.000 N	226.000 N	45
MR115	Open	5 mm	11 mm	4 mm	609.000 N	226.000 N	45
MR106	Open	6 mm	10 mm	2.5 mm	422.000 N	174.000 N	45
MR106 2rs	Sealed	6 mm	10 mm	3 mm	422.000 N	174.000 N	45
MR106zz	Shielded	6 mm	10 mm	3 mm	422.000 N	174.000 N	45
696	Open	6 mm	15 mm	5 mm	1139.000 N	418.000 N	40
626zz	Shielded	6 mm	19 mm	6 mm	1986.000 N	717.000 N	32
696zz	Shielded	6 mm	15 mm	5 mm	1139.000 N	418.000 N	40
606	Open	6 mm	17 mm	6 mm	1924.000 N	677.000 N	38
606zz	Shielded	6 mm	17 mm	6 mm	1924.000 N	677.000 N	38
626 2rs	Sealed	6 mm	19 mm	6 mm	1986.000 N	717.000 N	32
MR126	Open	6 mm	12 mm	3 mm	609.000 N	236.000 N	43
MR126 2rs	Sealed	6 mm	12 mm	4 mm	609.000 N	236.000 N	43

Section 5 Metric Standard

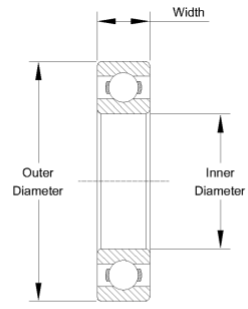

Standard Bearing (Open Type)

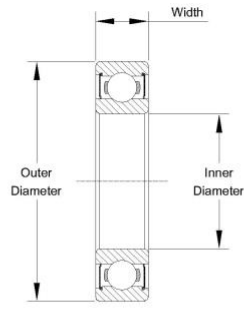

Sealed Bearing (Rubber Seal)

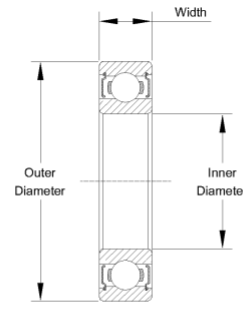

Sealed Bearing (Metal Shielded)

Part Number	Seal Type	Bore Dia	Outer Dia	Width	Dynamic Radial Load	Static Radial Load	Max Speed (X1000 rpm)
MR126zz	Shielded	6 mm	12 mm	4 mm	609.000 N	236.000 N	43
686	Open	6 mm	13 mm	3.5 mm	920.000 N	354.000 N	40
686 2rs	Sealed	6 mm	13 mm	5 mm	920.000 N	354.000 N	40
686zz	Shielded	6 mm	13 mm	5 mm	920.000 N	354.000 N	40
696 2rs	Sealed	6 mm	15 mm	5 mm	1139.000 N	418.000 N	40
606 2rs	Sealed	6 mm	17 mm	6 mm	1924.000 N	677.000 N	38
626	Open	6 mm	19 mm	6 mm	1986.000 N	717.000 N	32
636	Open	6 mm	22 mm	7 mm	2833.000 N	1138.000 N	30
636 2rs	Sealed	6 mm	22 mm	7 mm	2833.000 N	1138.000 N	30
636zz	Shielded	6 mm	22 mm	7 mm	2833.000 N	1138.000 N	30
MR117	Open	7 mm	11 mm	2.5 mm	387.000 N	162.000 N	43
MR117 2rs	Sealed	7 mm	11 mm	3 mm	387.000 N	162.000 N	43
MR117zz	Shielded	7 mm	11 mm	3 mm	387.000 N	162.000 N	43
MR137	Open	7 mm	13 mm	3 mm	460.000 N	221.000 N	40
MR137 2rs	Sealed	7 mm	13 mm	4 mm	460.000 N	221.000 N	40
MR137zz	Shielded	7 mm	13 mm	4 mm	460.000 N	221.000 N	40
687	Open	7 mm	14 mm	3.5 mm	997.000 N	410.000 N	40
687 2rs	Sealed	7 mm	14 mm	5 mm	997.000 N	410.000 N	40
687zz	Shielded	7 mm	14 mm	5 mm	997.000 N	410.000 N	40
697	Open	7 mm	17 mm	5 mm	1364.000 N	575.000 N	36
697 2rs	Sealed	7 mm	17 mm	5 mm	1364.000 N	575.000 N	36
697zz	Shielded	7 mm	17 mm	5 mm	1364.000 N	575.000 N	36
607	Open	7 mm	19 mm	6 mm	1986.000 N	717.000 N	36
607 2rs	Sealed	7 mm	19 mm	6 mm	1986.000 N	717.000 N	36
607zz	Shielded	7 mm	19 mm	6 mm	1986.000 N	717.000 N	36
627	Open	7 mm	22 mm	7 mm	2794.000 N	1103.000 N	30
627 2rs	Sealed	7 mm	22 mm	7 mm	2794.000 N	1103.000 N	30
627zz	Shielded	7 mm	22 mm	7 mm	2794.000 N	1103.000 N	30
637	Open	7 mm	26 mm	9 mm	3879.000 N	1586.000 N	28
637 2rs	Sealed	7 mm	26 mm	9 mm	3879.000 N	1586.000 N	28
637zz	Shielded	7 mm	26 mm	9 mm	3879.000 N	1586.000 N	28

Section 5 Metric Standard

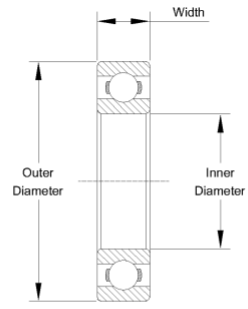

Standard Bearing (Open Type)

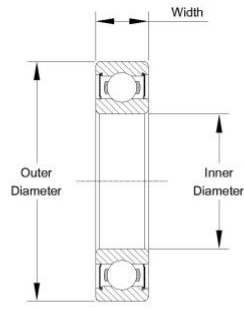

Sealed Bearing (Rubber Seal)

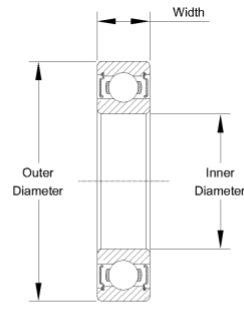

Sealed Bearing (Metal Shielded)

Part Number	Seal Type	Bore Dia	Outer Dia	Width	Dynamic Radial Load	Static Radial Load	Max Speed (X1000 rpm)
MR128 2rs	Sealed	8 mm	12 mm	3.5 mm	462.000 N	219.000 N	40
MR128zz	Shielded	8 mm	12 mm	3.5 mm	462.000 N	219.000 N	40
MR128	Open	8 mm	12 mm	2.5 mm	462.000 N	219.000 N	40
MR148	Open	8 mm	14 mm	3.5 mm	695.000 N	309.000 N	38
MR148 2rs	Sealed	8 mm	14 mm	4 mm	695.000 N	309.000 N	38
MR148zz	Shielded	8 mm	14 mm	4 mm	695.000 N	309.000 N	38
688	Open	8 mm	16 mm	4 mm	1064.000 N	474.000 N	36
688 2rs	Sealed	8 mm	16 mm	5 mm	1064.000 N	474.000 N	36
688zz	Shielded	8 mm	16 mm	5 mm	1064.000 N	474.000 N	36
698	Open	8 mm	19 mm	6 mm	1902.000 N	734.000 N	36
698 2rs	Sealed	8 mm	19 mm	6 mm	1902.000 N	734.000 N	36
698zz	Shielded	8 mm	19 mm	6 mm	1902.000 N	734.000 N	36
608	Open	8 mm	22 mm	7 mm	2799.000 N	1103.000 N	34
608 2rs	Sealed	8 mm	22 mm	7 mm	2799.000 N	1103.000 N	34
608zz	Shielded	8 mm	22 mm	7 mm	2799.000 N	1103.000 N	34
628	Open	8 mm	24 mm	8 mm	2833.000 N	1138.000 N	28
628 2rs	Sealed	8 mm	24 mm	8 mm	2833.000 N	1138.000 N	28
628zz	Shielded	8 mm	24 mm	8 mm	2833.000 N	1138.000 N	28
638	Open	8 mm	28 mm	9 mm	3879.000 N	1586.000 N	28
638 2rs	Sealed	8 mm	28 mm	9 mm	3879.000 N	1586.000 N	28
638zz	Shielded	8 mm	28 mm	9 mm	3879.000 N	1586.000 N	28
679	Open	9 mm	14 mm	3 mm	781.000 N	374.000 N	36
679 2rs	Sealed	9 mm	14 mm	4.5 mm	781.000 N	374.000 N	36
679zz	Shielded	9 mm	14 mm	4.5 mm	781.000 N	374.000 N	36
689	Open	9 mm	17 mm	4 mm	1128.000 N	534.000 N	36
689 2rs	Sealed	9 mm	17 mm	5 mm	1128.000 N	534.000 N	36
689zz	Shielded	9 mm	17 mm	5 mm	1128.000 N	534.000 N	36
699	Open	9 mm	20 mm	6 mm	2097.000 N	865.000 N	34
699 2rs	Sealed	9 mm	20 mm	6 mm	2097.000 N	865.000 N	34
699zz	Shielded	9 mm	20 mm	6 mm	2097.000 N	865.000 N	34
609	Open	9 mm	24 mm	7 mm	2853.000 N	1155.000 N	32

Section 5 Metric Standard

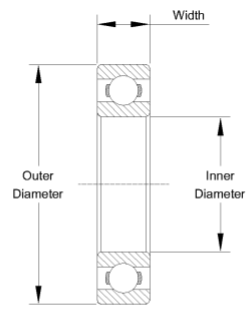

Standard Bearing (Open Type)

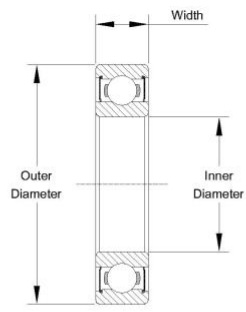

Sealed Bearing (Rubber Seal)

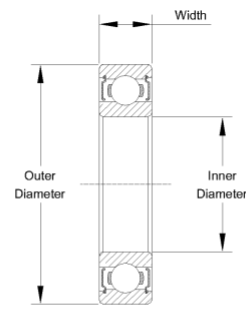

Sealed Bearing (Metal Shielded)

Part Number	Seal Type	Bore Dia	Outer Dia	Width	Dynamic Radial Load	Static Radial Load	Max Speed (X1000 rpm)
609 2rs	Sealed	9 mm	24 mm	7 mm	2853.000 N	1155.000 N	32
609zz	Shielded	9 mm	24 mm	7 mm	2853.000 N	1155.000 N	32
629	Open	9 mm	26 mm	8 mm	3879.000 N	1586.000 N	28
629 2rs	Sealed	9 mm	26 mm	8 mm	3879.000 N	1586.000 N	28
629zz	Shielded	9 mm	26 mm	8 mm	3879.000 N	1586.000 N	28
639	Open	9 mm	30 mm	10 mm	3960.000 N	1664.000 N	24
639 2rs	Sealed	9 mm	30 mm	10 mm	3960.000 N	1664.000 N	24
639zz	Shielded	9 mm	30 mm	10 mm	3960.000 N	1664.000 N	24

Section 6 *Metri Flanged*

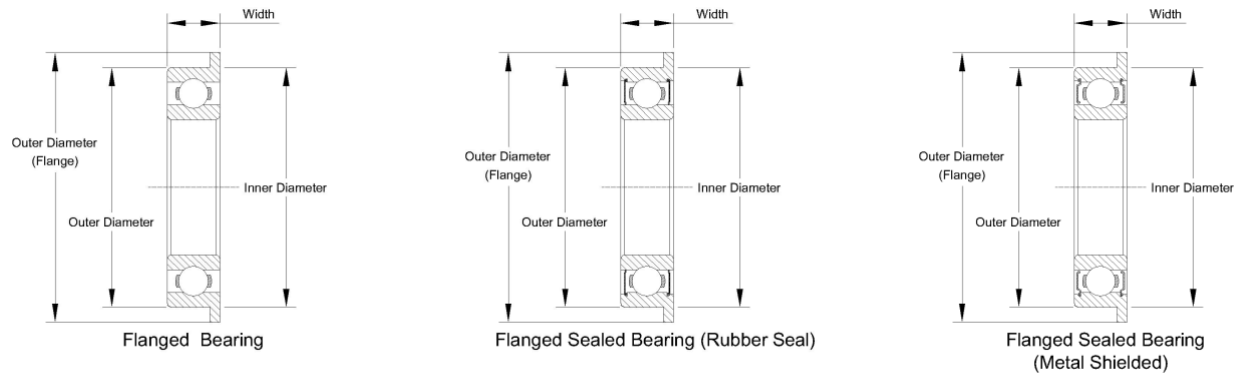

Part Number	Seal Type	Bore Dia	Outer Dia	Width	Flange Outer Dia	Flange Thickness	Dynamic Radial Load	Static Radial Load	Max Speed (X1000 rpm)
F681	Open	1 mm	3 mm	1 mm	3.8 mm	0.3 mm	82.000 N	21.000 N	130
F691	Open	1 mm	4 mm	1.6 mm	5 mm	0.5 mm	120.000 N	30.000 N	100
MF41x	Open	1.2 mm	4 mm	1.8 mm	4.8 mm	0.4 mm	95.000 N	26.000 N	110
F681x	Open	1.5 mm	4 mm	1.2 mm	5 mm	0.4 mm	95.000 N	26.000 N	100
F681xzz	Shielded	1.5 mm	4 mm	2 mm	5 mm	0.6 mm	95.000 N	26.000 N	100
F691x	Open	1.5 mm	5 mm	2 mm	6.5 mm	0.6 mm	144.000 N	40.000 N	85
F691xzz	Shielded	1.5 mm	5 mm	2.6 mm	6.5 mm	0.8 mm	144.000 N	40.000 N	85
F601x	Open	1.5 mm	6 mm	2.5 mm	7.5 mm	0.6 mm	281.000 N	79.000 N	75
F601xzz	Shielded	1.5 mm	6 mm	3 mm	7.5 mm	0.8 mm	281.000 N	79.000 N	75
F682	Open	2 mm	5 mm	1.5 mm	6.1 mm	0.5 mm	144.000 N	40.000 N	85
F682 2rs	Sealed	2 mm	5 mm	2.3 mm	6.1 mm	0.6 mm	144.000 N	40.000 N	85
F682zz	Shielded	2 mm	5 mm	2.3 mm	6.1 mm	0.6 mm	144.000 N	40.000 N	85
MF52	Open	2 mm	5 mm	2 mm	6.2 mm	0.6 mm	144.000 N	40.000 N	85
MF52 2rs	Sealed	2 mm	5 mm	2.5 mm	6.2 mm	0.6 mm	144.000 N	40.000 N	85
MF52zz	Shielded	2 mm	5 mm	2.5 mm	6.2 mm	0.6 mm	144.000 N	40.000 N	85
F692	Open	2 mm	6 mm	2.3 mm	7.5 mm	0.6 mm	281.000 N	79.000 N	75
F692 2rs	Sealed	2 mm	6 mm	3 mm	7.5 mm	0.8 mm	281.000 N	79.000 N	75
F692zz	Shielded	2 mm	6 mm	3 mm	7.5 mm	0.8 mm	281.000 N	79.000 N	75
MF62	Open	2 mm	6 mm	2.5 mm	7.2 mm	0.6 mm	281.000 N	79.000 N	75
MF62 2rs	Sealed	2 mm	6 mm	2.5 mm	7.2 mm	0.6 mm	281.000 N	79.000 N	75
MF62zz	Shielded	2 mm	6 mm	2.5 mm	7.2 mm	0.6 mm	281.000 N	79.000 N	75
MF72	Open	2 mm	7 mm	2.5 mm	8.2 mm	0.6 mm	328.000 N	103.000 N	63
MF72 2rs	Sealed	2 mm	7 mm	3 mm	8.2 mm	0.6 mm	328.000 N	103.000 N	63
MF72zz	Shielded	2 mm	7 mm	3 mm	8.2 mm	0.6 mm	328.000 N	103.000 N	63
F602	Open	2 mm	7 mm	2.8 mm	8.5 mm	0.7 mm	328.000 N	103.000 N	60
F602 2rs	Sealed	2 mm	7 mm	3.5 mm	8.5 mm	0.9 mm	328.000 N	103.000 N	60
F602zz	Shielded	2 mm	7 mm	3.5 mm	8.5 mm	0.9 mm	328.000 N	103.000 N	60
F682x	Open	2.5 mm	6 mm	1.8 mm	7.1 mm	0.5 mm	178.000 N	59.000 N	71
F682x 2rs	Sealed	2.5 mm	6 mm	2.6 mm	7.1 mm	0.8 mm	178.000 N	59.000 N	71
F682xzz	Shielded	2.5 mm	6 mm	2.6 mm	7.1 mm	0.8 mm	178.000 N	59.000 N	71

* We produce stainless steel miniature bearings, please send RFQ or talk to sales representatives.

Section 6 Metri Flanged

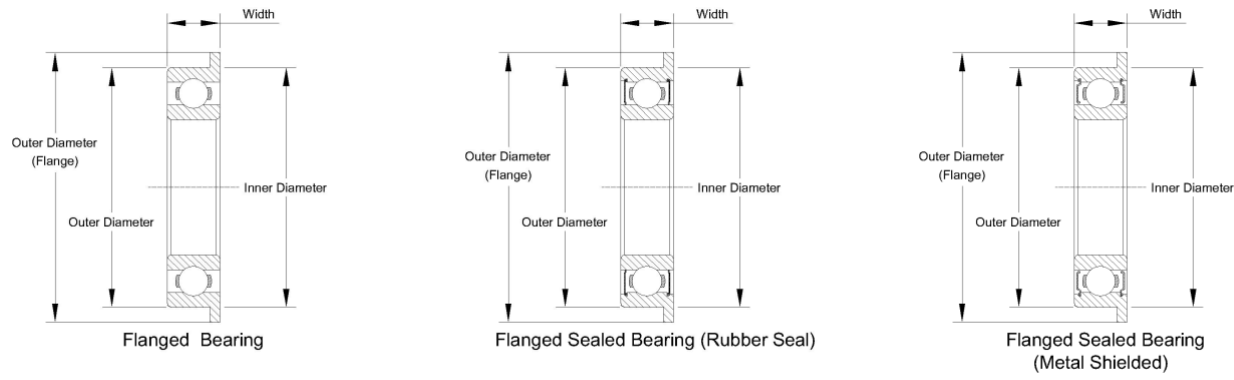

Part Number	Seal Type	Bore Dia	Outer Dia	Width	Flange Outer Dia	Flange Thickness	Dynamic Radial Load	Static Radial Load	Max Speed (X1000 rpm)
F692x	Open	2.5 mm	7 mm	2.5 mm	8.5 mm	0.7 mm	328.000 N	103.000 N	63
F692x 2rs	Sealed	2.5 mm	7 mm	3.5 mm	8.5 mm	0.9 mm	328.000 N	103.000 N	63
F692zzz	Shielded	2.5 mm	7 mm	3.5 mm	8.5 mm	0.9 mm	328.000 N	103.000 N	63
MF82x	Open	2.5 mm	8 mm	2.5 mm	9.2 mm	0.6 mm	180.000 N	67.000 N	71
MF82x 2rs	Sealed	2.5 mm	8 mm	2.5 mm	9.2 mm	0.6 mm	180.000 N	67.000 N	71
MF82zzz	Shielded	2.5 mm	8 mm	2.5 mm	9.2 mm	0.6 mm	180.000 N	67.000 N	71
F602x	Open	2.5 mm	8 mm	2.8 mm	9.5 mm	0.7 mm	469.000 N	142.000 N	60
F602x 2rs	Sealed	2.5 mm	8 mm	4 mm	9.5 mm	0.9 mm	328.000 N	103.000 N	60
F602zzz	Shielded	2.5 mm	8 mm	4 mm	9.5 mm	0.9 mm	469.000 N	142.000 N	60
MF63	Open	3 mm	6 mm	2 mm	7.2 mm	0.6 mm	178.000 N	59.000 N	71
MF63 2rs	Sealed	3 mm	6 mm	2.5 mm	7.2 mm	0.6 mm	178.000 N	59.000 N	71
MF63zzz	Shielded	3 mm	6 mm	2.5 mm	7.2 mm	0.6 mm	178.000 N	59.000 N	71
F683	Open	3 mm	7 mm	2 mm	8.1 mm	0.5 mm	264.000 N	90.000 N	63
F683 2rs	Sealed	3 mm	7 mm	3 mm	8.1 mm	0.8 mm	264.000 N	90.000 N	63
F683zzz	Shielded	3 mm	7 mm	3 mm	8.1 mm	0.8 mm	264.000 N	90.000 N	63
MF83	Open	3 mm	8 mm	2.5 mm	9.2 mm	0.6 mm	336.000 N	113.000 N	60
MF83 2rs	Sealed	3 mm	8 mm	3 mm	9.2 mm	0.6 mm	336.000 N	113.000 N	60
MF83zzz	Shielded	3 mm	8 mm	3 mm	9.2 mm	0.6 mm	336.000 N	113.000 N	60
F693	Open	3 mm	8 mm	3 mm	9.5 mm	0.7 mm	474.000 N	114.000 N	60
F693 2rs	Sealed	3 mm	8 mm	4 mm	9.5 mm	0.9 mm	474.000 N	144.000 N	60
F693zzz	Shielded	3 mm	8 mm	4 mm	9.5 mm	0.9 mm	474.000 N	144.000 N	60
MF93	Open	3 mm	9 mm	2.5 mm	10.2 mm	0.6 mm	485.000 N	151.000 N	56
MF93 2rs	Sealed	3 mm	9 mm	4 mm	10.6 mm	0.8 mm	485.000 N	151.000 N	56
MF93zzz	Shielded	3 mm	9 mm	4 mm	10.6 mm	0.8 mm	485.000 N	151.000 N	56
F603	Open	3 mm	9 mm	3 mm	10.5 mm	0.7 mm	230.000 N	151.000 N	56
F603 2rs	Sealed	3 mm	9 mm	3 mm	10.5 mm	0.7 mm	230.000 N	151.000 N	56
F603zzz	Shielded	3 mm	9 mm	3 mm	10.5 mm	0.7 mm	230.000 N	151.000 N	56
F623	Open	3 mm	10 mm	4 mm	11.5 mm	1 mm	536.000 N	175.000 N	50
F623 2rs	Sealed	3 mm	10 mm	4 mm	11.5 mm	1 mm	536.000 N	175.000 N	50
F623zzz	Shielded	3 mm	10 mm	4 mm	11.5 mm	1 mm	536.000 N	175.000 N	50

Section 6 Metri Flanged

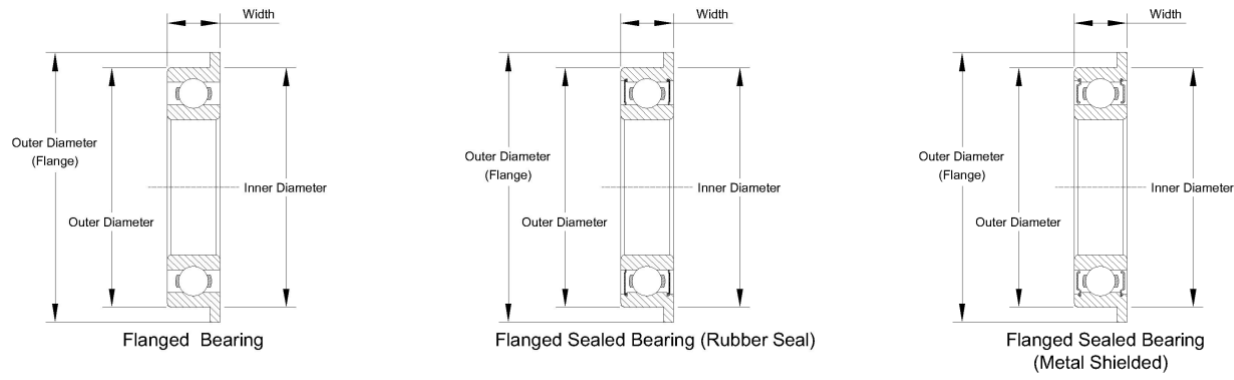

Part Number	Seal Type	Bore Dia	Outer Dia	Width	Flange Outer Dia	Flange Thickness	Dynamic Radial Load	Static Radial Load	Max Speed (X1000 rpm)
MF74	Open	4 mm	7 mm	2 mm	8.2 mm	0.6 mm	264.000 N	92.000 N	60
MF74 2rs	Sealed	4 mm	7 mm	2.5 mm	8.2 mm	0.6 mm	217.000 N	86.000 N	60
MF74zz	Shielded	4 mm	7 mm	2.5 mm	8.2 mm	0.6 mm	217.000 N	86.000 N	60
MF84	Open	4 mm	8 mm	2 mm	9.2 mm	0.6 mm	336.000 N	113.000 N	56
MF84 2rs	Sealed	4 mm	8 mm	3 mm	9.2 mm	0.6 mm	336.000 N	113.000 N	56
MF84zz	Shielded	4 mm	8 mm	3 mm	9.2 mm	0.6 mm	336.000 N	113.000 N	56
F684	Open	4 mm	9 mm	2.5 mm	10.3 mm	0.6 mm	545.000 N	182.000 N	53
F684 2rs	Sealed	4 mm	9 mm	4 mm	10.3 mm	1 mm	545.000 N	182.000 N	53
F684zz	Shielded	4 mm	9 mm	4 mm	10.3 mm	1 mm	545.000 N	182.000 N	53
MF104	Open	4 mm	10 mm	3 mm	11.2 mm	0.6 mm	604.000 N	218.000 N	48
MF104 2rs	Sealed	4 mm	10 mm	4 mm	11.6 mm	0.8 mm	604.000 N	218.000 N	48
MF104zz	Shielded	4 mm	10 mm	4 mm	11.6 mm	0.8 mm	604.000 N	218.000 N	48
F694	Open	4 mm	11 mm	4 mm	12.5 mm	1 mm	814.000 N	280.000 N	48
F694 2rs	Sealed	4 mm	11 mm	4 mm	12.5 mm	1 mm	814.000 N	280.000 N	48
F694zz	Shielded	4 mm	11 mm	4 mm	12.5 mm	1 mm	814.000 N	280.000 N	48
F604	Open	4 mm	12 mm	4 mm	13.5 mm	1 mm	814.000 N	280.000 N	48
F604 2rs	Sealed	4 mm	12 mm	4 mm	13.5 mm	1 mm	814.000 N	280.000 N	48
F604zz	Shielded	4 mm	12 mm	4 mm	13.5 mm	1 mm	814.000 N	280.000 N	48
F624	Open	4 mm	13 mm	5 mm	15 mm	1 mm	1106.000 N	390.000 N	40
F624 2rs	Sealed	4 mm	13 mm	5 mm	15 mm	1 mm	1106.000 N	390.000 N	40
F624zz	Shielded	4 mm	13 mm	5 mm	15 mm	1 mm	1106.000 N	390.000 N	40
F634	Open	4 mm	16 mm	5 mm	18 mm	1 mm	1139.000 N	418.000 N	36
F634 2rs	Sealed	4 mm	16 mm	5 mm	18 mm	1 mm	1139.000 N	418.000 N	36
F634zz	Shielded	4 mm	16 mm	5 mm	18 mm	1 mm	1139.000 N	418.000 N	36
MF85	Open	5 mm	8 mm	2 mm	9.2 mm	0.6 mm	262.000 N	96.000 N	53
MF85 2rs	Sealed	5 mm	8 mm	2.5 mm	9.2 mm	0.6 mm	185.000 N	72.000 N	53
MF85zz	Shielded	5 mm	8 mm	2.5 mm	9.2 mm	0.6 mm	185.000 N	72.000 N	53
MF95	Open	5 mm	9 mm	2.5 mm	10.2 mm	0.6 mm	366.000 N	135.000 N	50
MF95 2rs	Sealed	5 mm	9 mm	3 mm	10.2 mm	0.6 mm	366.000 N	135.000 N	50
MF95zz	Shielded	5 mm	9 mm	3 mm	10.2 mm	0.6 mm	366.000 N	135.000 N	50

Section 6 *Metri Flanged*

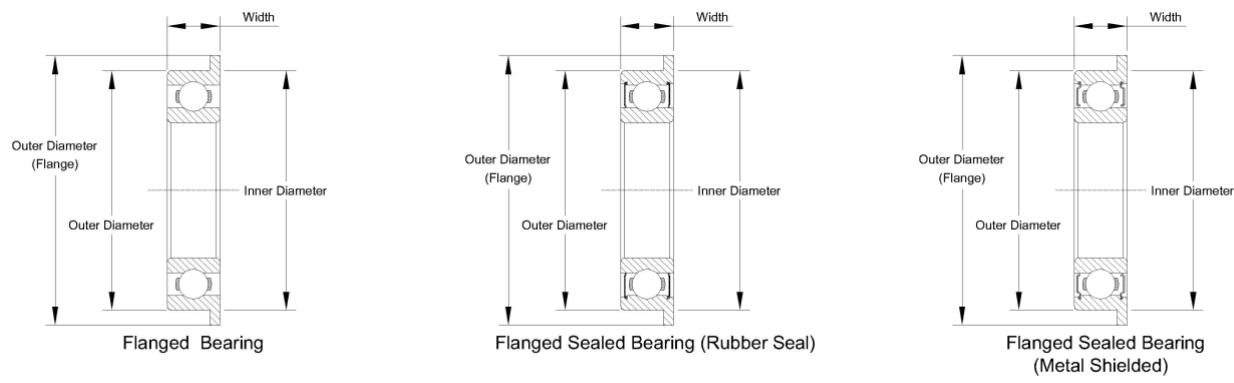

Part Number	Seal Type	Bore Dia	Outer Dia	Width	Flange Outer Dia	Flange Thickness	Dynamic Radial Load	Static Radial Load	Max Speed (X1000 rpm)
MF105	Open	5 mm	10 mm	3 mm	11.2 mm	0.6 mm	366.000 N	135.000 N	50
MF105 2rs	Sealed	5 mm	10 mm	4 mm	11.6 mm	0.8 mm	366.000 N	135.000 N	50
MF105zz	Shielded	5 mm	10 mm	4 mm	11.6 mm	0.8 mm	366.000 N	135.000 N	50
MF115 2rs	Sealed	5 mm	11 mm	4 mm	12.6 mm	0.8 mm	609.000 N	226.000 N	45
MF115zz	Shielded	5 mm	11 mm	4 mm	12.6 mm	0.8 mm	609.000 N	226.000 N	45
MF115	Open	5 mm	11 mm	4 mm	12.6 mm	0.8 mm	609.000 N	226.000 N	45
F685	Open	5 mm	11 mm	3 mm	12.5 mm	0.8 mm	609.000 N	226.000 N	45
F685 2rs	Sealed	5 mm	11 mm	5 mm	12.5 mm	1 mm	609.000 N	226.000 N	45
F685zz	Shielded	5 mm	11 mm	5 mm	12.5 mm	1 mm	609.000 N	226.000 N	45
F695	Open	5 mm	13 mm	4 mm	15 mm	1 mm	916.000 N	346.000 N	43
F695 2rs	Sealed	5 mm	13 mm	4 mm	15 mm	1 mm	916.000 N	346.000 N	43
F695zz	Shielded	5 mm	13 mm	4 mm	15 mm	1 mm	916.000 N	346.000 N	43
F605	Open	5 mm	14 mm	5 mm	16 mm	1 mm	1130.000 N	406.000 N	40
F605 2rs	Sealed	5 mm	14 mm	5 mm	16 mm	1 mm	1130.000 N	406.000 N	40
F605zz	Shielded	5 mm	14 mm	5 mm	16 mm	1 mm	1130.000 N	406.000 N	40
F625	Open	5 mm	16 mm	5 mm	18 mm	1 mm	1470.000 N	540.000 N	36
F625 2rs	Sealed	5 mm	16 mm	5 mm	18 mm	1 mm	1470.000 N	540.000 N	36
F625zz	Shielded	5 mm	16 mm	5 mm	18 mm	1 mm	1470.000 N	540.000 N	36
F635	Open	5 mm	19 mm	6 mm	22 mm	1.5 mm	1986.000 N	717.000 N	32
F635 2rs	Sealed	5 mm	19 mm	6 mm	22 mm	1.5 mm	1986.000 N	717.000 N	32
F635zz	Shielded	5 mm	19 mm	6 mm	22 mm	1.5 mm	1986.000 N	717.000 N	32
MF106	Open	6 mm	10 mm	2.5 mm	11.2 mm	0.6 mm	422.000 N	174.000 N	45
MF106 2rs	Sealed	6 mm	10 mm	3 mm	11.2 mm	0.6 mm	422.000 N	174.000 N	45
MF106zz	Shielded	6 mm	10 mm	3 mm	11.2 mm	0.6 mm	422.000 N	174.000 N	45
MF126	Open	6 mm	12 mm	3 mm	13.2 mm	0.6 mm	609.000 N	236.000 N	43
MF126 2rs	Sealed	6 mm	12 mm	4 mm	13.6 mm	0.8 mm	609.000 N	236.000 N	43
MF126zz	Shielded	6 mm	12 mm	4 mm	13.6 mm	0.8 mm	609.000 N	236.000 N	43
F686	Open	6 mm	13 mm	3.5 mm	15 mm	1 mm	920.000 N	354.000 N	40
F686 2rs	Sealed	6 mm	13 mm	5 mm	15 mm	1.1 mm	920.000 N	354.000 N	40
F686zz	Shielded	6 mm	13 mm	5 mm	15 mm	1.1 mm	920.000 N	354.000 N	40

Section 6 *Metri Flanged*

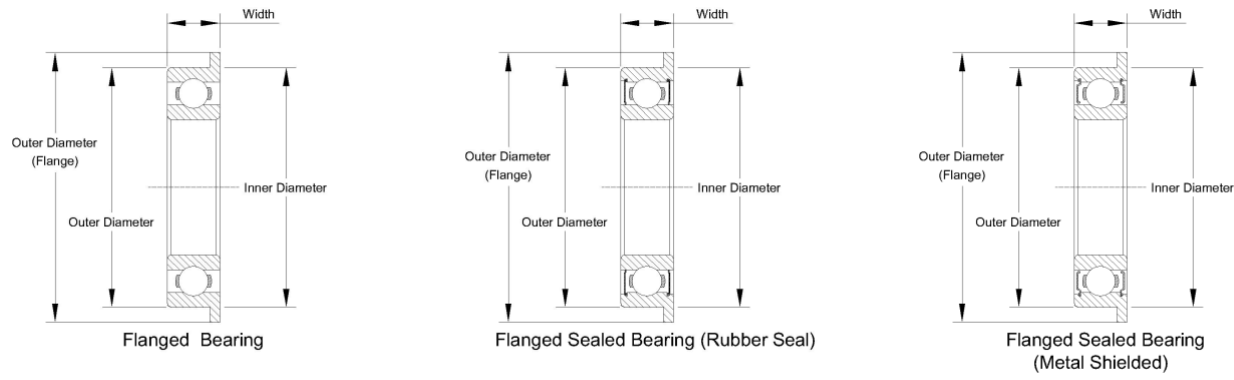

Part Number	Seal Type	Bore Dia	Outer Dia	Width	Flange Outer Dia	Flange Thickness	Dynamic Radial Load	Static Radial Load	Max Speed (X1000 rpm)
F696	Open	6 mm	15 mm	5 mm	17 mm	1.2 mm	1139.000 N	418.000 N	40
F696 2rs	Sealed	6 mm	15 mm	5 mm	17 mm	1.2 mm	1139.000 N	418.000 N	40
F696zz	Shielded	6 mm	15 mm	5 mm	17 mm	1.2 mm	1139.000 N	418.000 N	40
F606	Open	6 mm	17 mm	6 mm	19 mm	1.2 mm	1924.000 N	677.000 N	38
F606 2rs	Sealed	6 mm	17 mm	6 mm	19 mm	1.2 mm	1924.000 N	677.000 N	38
F606zz	Shielded	6 mm	17 mm	6 mm	19 mm	1.2 mm	1924.000 N	677.000 N	38
F626	Open	6 mm	19 mm	6 mm	22 mm	1.5 mm	1986.000 N	717.000 N	32
F626 2rs	Sealed	6 mm	19 mm	6 mm	22 mm	1.5 mm	1986.000 N	717.000 N	32
F626zz	Shielded	6 mm	19 mm	6 mm	22 mm	1.5 mm	1986.000 N	717.000 N	32
MF117	Open	7 mm	11 mm	2.5 mm	12.2 mm	0.6 mm	387.000 N	162.000 N	43
MF117 2rs	Sealed	7 mm	11 mm	3 mm	12.2 mm	0.6 mm	387.000 N	162.000 N	43
MF117zz	Shielded	7 mm	11 mm	3 mm	12.2 mm	0.6 mm	387.000 N	162.000 N	43
MF137	Open	7 mm	13 mm	3 mm	14.2 mm	0.6 mm	460.000 N	221.000 N	40
MF137 2rs	Sealed	7 mm	13 mm	4 mm	14.6 mm	0.8 mm	460.000 N	221.000 N	40
MF137zz	Shielded	7 mm	13 mm	4 mm	14.6 mm	0.8 mm	460.000 N	221.000 N	40
F687	Open	7 mm	14 mm	3.5 mm	16 mm	1 mm	997.000 N	410.000 N	40
F687 2rs	Sealed	7 mm	14 mm	5 mm	16 mm	1.1 mm	997.000 N	410.000 N	40
F687zz	Shielded	7 mm	14 mm	5 mm	16 mm	1.1 mm	997.000 N	410.000 N	40
F697	Open	7 mm	17 mm	5 mm	19 mm	1.2 mm	1364.000 N	575.000 N	36
F697 2rs	Sealed	7 mm	17 mm	5 mm	19 mm	1.2 mm	1364.000 N	575.000 N	36
F697zz	Shielded	7 mm	17 mm	5 mm	19 mm	1.2 mm	1364.000 N	575.000 N	36
F607	Open	7 mm	19 mm	6 mm	22 mm	1.5 mm	1986.000 N	717.000 N	36
F607 2rs	Sealed	7 mm	19 mm	6 mm	22 mm	1.5 mm	1986.000 N	717.000 N	36
F607zz	Shielded	7 mm	19 mm	6 mm	22 mm	1.5 mm	1986.000 N	717.000 N	36
F627	Open	7 mm	22 mm	7 mm	25 mm	1.5 mm	2794.000 N	1103.000 N	30
F627 2rs	Sealed	7 mm	22 mm	7 mm	25 mm	1.5 mm	2794.000 N	1103.000 N	30
F627zz	Shielded	7 mm	22 mm	7 mm	25 mm	1.5 mm	2794.000 N	1103.000 N	30
MF128	Open	8 mm	12 mm	2.5 mm	13.2 mm	0.6 mm	462.000 N	219.000 N	40
MF128 2rs	Sealed	8 mm	12 mm	3.5 mm	13.6 mm	0.8 mm	462.000 N	219.000 N	40
MF128zz	Shielded	8 mm	12 mm	3.5 mm	13.6 mm	0.8 mm	462.000 N	219.000 N	40

Section 6 *Metri Flanged*

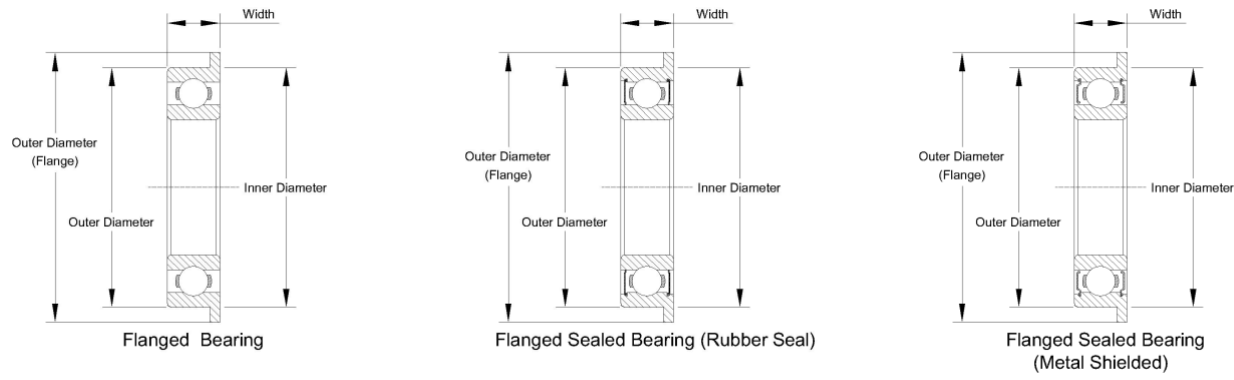

Part Number	Seal Type	Bore Dia	Outer Dia	Width	Flange Outer Dia	Flange Thickness	Dynamic Radial Load	Static Radial Load	Max Speed (X1000 rpm)
MF148	Open	8 mm	14 mm	3.5 mm	15.6 mm	0.8 mm	695.000 N	309.000 N	38
MF148 2rs	Sealed	8 mm	14 mm	4 mm	15.6 mm	0.8 mm	695.000 N	309.000 N	38
MF148zz	Shielded	8 mm	14 mm	4 mm	15.6 mm	0.8 mm	695.000 N	309.000 N	38
F688	Open	8 mm	16 mm	4 mm	18 mm	1 mm	1064.000 N	474.000 N	36
F688 2rs	Sealed	8 mm	16 mm	5 mm	18 mm	1.1 mm	1064.000 N	474.000 N	36
F688zz	Shielded	8 mm	16 mm	5 mm	18 mm	1.1 mm	1064.000 N	474.000 N	36
F698	Open	8 mm	19 mm	6 mm	22 mm	1.5 mm	1902.000 N	734.000 N	36
F698 2rs	Sealed	8 mm	19 mm	6 mm	22 mm	1.5 mm	1902.000 N	734.000 N	36
F698zz	Shielded	8 mm	19 mm	6 mm	22 mm	1.5 mm	1902.000 N	734.000 N	36
F608	Open	8 mm	22 mm	7 mm	25 mm	1.5 mm	2799.000 N	1103.000 N	34
F608 2rs	Sealed	8 mm	22 mm	7 mm	25 mm	1.5 mm	2799.000 N	1103.000 N	34
F608zz	Shielded	8 mm	22 mm	7 mm	25 mm	1.5 mm	2799.000 N	1103.000 N	34
F679	Open	9 mm	14 mm	3 mm	15.5 mm	0.8 mm	781.000 N	374.000 N	36
F679 2rs	Sealed	9 mm	14 mm	4.5 mm	15.5 mm	0.8 mm	781.000 N	374.000 N	36
F679zz	Shielded	9 mm	14 mm	4.5 mm	15.5 mm	0.8 mm	781.000 N	374.000 N	36
F689	Open	9 mm	17 mm	4 mm	19 mm	1 mm	1128.000 N	534.000 N	36
F689 2rs	Sealed	9 mm	17 mm	5 mm	19 mm	1.1 mm	1128.000 N	534.000 N	36
F689zz	Shielded	9 mm	17 mm	5 mm	19 mm	1.1 mm	1128.000 N	534.000 N	36
F699	Open	9 mm	20 mm	6 mm	23 mm	1.5 mm	2097.000 N	865.000 N	34
F699 2rs	Sealed	9 mm	20 mm	6 mm	23 mm	1.5 mm	2097.000 N	865.000 N	34
F699zz	Shielded	9 mm	20 mm	6 mm	23 mm	1.5 mm	2097.000 N	865.000 N	34
F609	Open	9 mm	24 mm	7 mm	27 mm	1.5 mm	2853.000 N	1155.000 N	32
F609 2rs	Sealed	9 mm	24 mm	7 mm	27 mm	1.5 mm	2853.000 N	1155.000 N	32
F609zz	Shielded	9 mm	24 mm	7 mm	27 mm	1.5 mm	2853.000 N	1155.000 N	32

Section 7 *Metri Thrust*

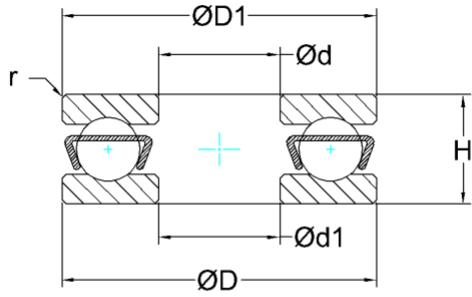

Miniature Thrust Bearing With Grooved Raceways

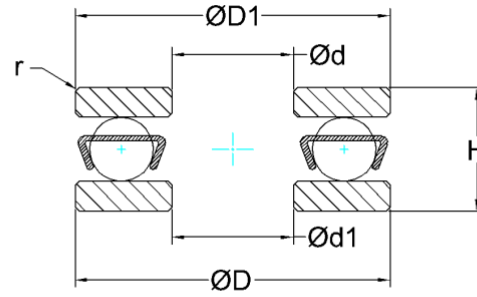

Miniature Thrust Bearing With Flat Raceways

Part Number	Washers Type	Shaft Washer ID	Housing Washer OD	Height	Dynamic Thrust Load	Static Thrust Load	Max Speed (X1000 rpm)
F2-6	flat raceway	2 mm	6 mm	3 mm	117.000 N	83.000 N	16
F2X-7	flat raceway	2.5 mm	7 mm	3.5 mm	156.000 N	117.000 N	15
F3-8	flat raceway	3 mm	8 mm	3.5 mm	600.000 N	480.000 N	11
F3-8M	grooved raceway	3 mm	8 mm	3.5 mm	600.000 N	480.000 N	11
F4-10	flat raceway	4 mm	10 mm	4 mm	658.000 N	580.000 N	6
F4-10M	grooved raceway	4 mm	10 mm	4 mm	658.000 N	580.000 N	6
F4-9	flat raceway	4 mm	9 mm	4 mm	800.000 N	520.000 N	8
F4-9M	grooved raceway	4 mm	9 mm	4 mm	800.000 N	520.000 N	8
F5-11M	grooved raceway	5 mm	11 mm	4.5 mm	988.000 N	880.000 N	5
F5-12M	grooved raceway	5 mm	12 mm	4 mm	988.000 N	880.000 N	5
F5-10M	grooved raceway	5 mm	10 mm	4 mm	950.000 N	830.000 N	5.1
F5-11	flat raceway	5 mm	11 mm	4.5 mm	988.000 N	880.000 N	5
F6-12	flat raceway	6 mm	12 mm	4.5 mm	1600.000 N	1255.000 N	5
F6-12M	grooved raceway	6 mm	12 mm	4.5 mm	1600.000 N	1255.000 N	5
F6-13M	grooved raceway	6 mm	13 mm	5 mm	1600.000 N	1255.000 N	5
F6-14M	grooved raceway	6 mm	14 mm	5 mm	1800.000 N	1588.000 N	4
F7-13M	grooved raceway	7 mm	13 mm	4.5 mm	1422.000 N	1255.000 N	4
F7-15	flat raceway	7 mm	15 mm	5 mm	2200.000 N	2000.000 N	3.6
F7-15M	grooved raceway	7 mm	15 mm	5 mm	2200.000 N	2000.000 N	3.6
F7-17M	grooved raceway	7 mm	17 mm	6 mm	2600.000 N	2256.000 N	3.5
F8-16	flat raceway	8 mm	16 mm	5 mm	2500.000 N	3000.000 N	4
F8-16M	grooved raceway	8 mm	16 mm	5 mm	2500.000 N	3000.000 N	4
F8-19M	grooved raceway	8 mm	19 mm	7 mm	3452.000 N	3000.000 N	3
F9-17	flat raceway	9 mm	17 mm	5 mm	578.000 N	627.000 N	8
F9-20M	grooved raceway	9 mm	20 mm	7 mm	3356.000 N	2999.000 N	2.5
F10-18	flat raceway	10 mm	18 mm	5.5 mm	2230.000 N	2721.000 N	2.5
F10-18M	grooved raceway	10 mm	18 mm	5.5 mm	2230.000 N	2721.000 N	2.5

* We produce stainless steel miniature bearings, please send RFQ or talk to sales representatives.