

Bearings

Angular Contact Ball Bearings



LB

Table of Contents



Single Row Angular Contact Ball Bearings

1.70 Series Angular Contact Bearings.....	2
2.72 Series Angular Contact Bearings.....	4
3.73 Series Angular Contact Bearings.....	6
4.79 Series Angular Contact Bearings.....	8

Double Row Angular Contact Ball Bearings

1.52 Series Angular Contact Bearings.....	10
2.53 Series Angular Contact Bearings.....	14

Super Precision High Speed Angular Contact Ball Bearings.....	17
--	-----------



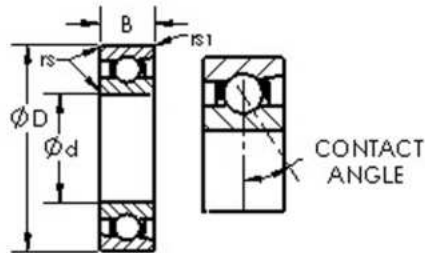

Product Number	Bore Dia (d)	Outer Dia (D)	Width (B)	Dynamic Load Rating (Cr) (kN)	Static Load Rating (Cor) (kN)
7000	10 mm	26mm	8mm	4.65	2.07
7001	12 mm	28 mm	8 mm	5.05	2.46
7002	15 mm	32 mm	9 mm	5.8	3.15
7003	17 mm	35 mm	10 mm	7.15	3.85
7004	20 mm	42mm	12mm	9.7	5.6
7005	25 mm	47mm	12mm	10.7	6.85
7006	30 mm	55mm	13mm	13.9	9.45
7007	35 mm	62mm	14mm	17.5	12.6
7008	40 mm	68mm	15mm	18.8	14.6
7009	45 mm	75mm	16mm	22.3	17.7
7010	50 mm	80mm	16mm	23.7	20.1
7011	55 mm	90mm	18mm	31	26.3
7012	60 mm	95mm	18mm	32	28.1
7013	65 mm	100mm	18mm	33.5	31.5
7014	70 mm	110mm	20mm	42.5	39.5
7015	75 mm	115mm	20mm	43.5	41.5
7016	80 mm	125mm	22mm	53.5	50.5

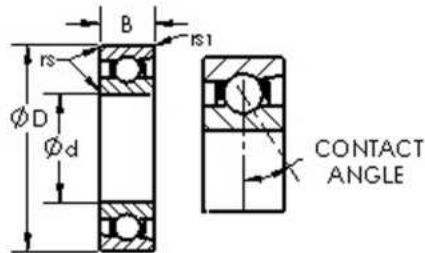

Product Number	Bore Dia (d)	Outer Dia (D)	Width (B)	Dynamic Load Rating (Cr) (kN)	Static Load Rating (Cor) (kN)
7017	85 mm	130mm	22mm	54.5	53.5
7018	90 mm	140mm	24mm	65	63.5
7019	95 mm	145mm	24mm	67	67
7020	100 mm	150mm	24mm	68.5	70.5
7021	105 mm	160mm	26mm	80	81.5
7022	110 mm	170mm	28mm	92	93
7024	120 mm	180mm	28mm	93.5	98.5
7026	130 mm	200mm	33mm	117	125
7028	140 mm	210mm	33mm	120	133
7030	150 mm	225mm	35mm	137	154
7032	160 mm	240mm	38mm	155	176
7034	170 mm	260mm	42mm	186	214
7036	180 mm	280mm	46mm	219	266
7038	190 mm	290mm	46mm	224	280
7040	200 mm	310mm	51mm	252	325

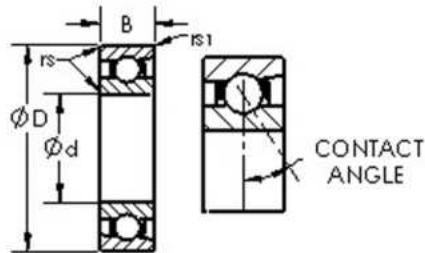

Product Number	Bore Dia (d)	Outer Dia (D)	Width (B)	Dynamic Load Rating (Cr) (kN)	Static Load Rating (Cor) (kN)
7200	10 mm	30 mm	9 mm	5.45	2.74
7201	12 mm	32mm	10mm	7.6	3.95
7202	15 mm	35mm	11mm	9.05	4.7
7203	17 mm	40mm	12mm	12	6.6
7204	20 mm	47mm	14mm	14.5	8.4
7205	25 mm	52mm	15mm	16.2	10.3
7206	30 mm	62mm	16mm	22.5	14.8
7207	35 mm	72mm	17mm	29.7	20.1
7208	40 mm	80mm	18mm	35.5	25.1
7209	45 mm	85mm	19mm	39.5	28.7
7210	50 mm	90mm	20mm	41.5	31.5
7211	55 mm	100mm	21mm	51	39.5
7212	60 mm	110mm	22mm	61.5	49
7213	65 mm	120mm	23mm	70.5	58
7214	70 mm	125mm	24mm	76.5	63.5
7215	75 mm	130mm	25mm	79	68.5
7216	80 mm	140mm	26mm	89	76

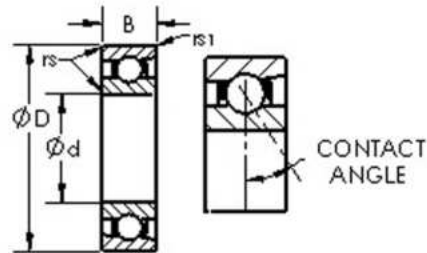

Product Number	Bore Dia (d)	Outer Dia (D)	Width (B)	Dynamic Load Rating (Cr) (kN)	Static Load Rating (Cor) (kN)
7217	85 mm	150mm	28mm	99.5	88.5
7218	90 mm	160mm	30mm	118	103
7219	95 mm	170mm	32mm	133	118
7220	100 mm	180mm	34mm	144	126
7221	105 mm	190mm	36mm	157	142
7222	110 mm	200mm	38mm	170	158
7224	120 mm	215mm	40mm	183	177
7226	130 mm	230mm	40mm	196	198
7228	140 mm	250mm	42mm	203	215
7230	150 mm	270mm	45mm	232	259
7232	160 mm	290mm	48mm	263	305
7234	170 mm	310mm	52mm	295	360
7236	180 mm	320mm	52mm	305	385
7238	190 mm	340mm	55mm	305	390
7240	200 mm	360mm	58mm	335	450

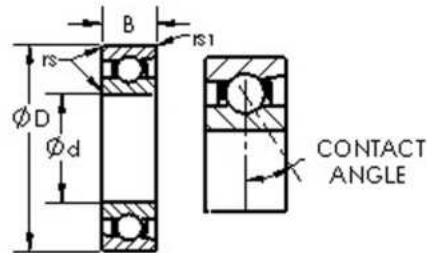

Product Number	Bore Dia (d)	Outer Dia (D)	Width (B)	Dynamic Load Rating (Cr) (kN)	Static Load Rating (Cor) (kN)
7300	10 mm	35 mm	11 mm	10.1	4.95
7301	12 mm	37 mm	12 mm	11.2	5.25
7302	15 mm	42 mm	13 mm	13.5	7.2
7303	17 mm	47 mm	14 mm	15.9	8.65
7304	20 mm	52 mm	15 mm	18.7	10.6
7305	25 mm	62 mm	17 mm	26.4	15.8
7306	30 mm	72 mm	19 mm	33.5	22.3
7307	35 mm	80 mm	21 mm	40	26.3
7308	40 mm	90 mm	23 mm	49	33
7309	45 mm	100 mm	25 mm	63.5	44
7310	50 mm	110 mm	27 mm	74	52
7311	55 mm	120 mm	29 mm	86	61.5
7312	60 mm	130 mm	31 mm	98	71.5
7313	65 mm	140 mm	33 mm	111	82
7314	70 mm	150 mm	35 mm	125	93.5
7315	75 mm	160 mm	37 mm	136	106
7316	80 mm	170 mm	39 mm	147	119

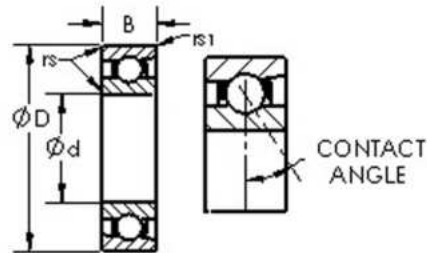

Product Number	Bore Dia (d)	Outer Dia (D)	Width (B)	Dynamic Load Rating (Cr) (kN)	Static Load Rating (Cor) (kN)
7317	85 mm	180 mm	41 mm	159	133
7318	90 mm	190 mm	43 mm	171	147
7319	95 mm	200 mm	45 mm	183	162
7320	100 mm	215 mm	47 mm	207	193
7321	105 mm	225 mm	49 mm	220	210
7322	110 mm	240 mm	50 mm	246	246
7324	120 mm	260 mm	55 mm	246	252
7326	130 mm	280 mm	58 mm	273	293
7328	140 mm	300 mm	62 mm	300	335
7330	150 mm	320 mm	65 mm	330	380
7332	160 mm	340 mm	68 mm	345	420
7334	170 mm	360 mm	72 mm	390	485
7336	180 mm	380 mm	75 mm	410	535
7338	190 mm	400 mm	78 mm	430	585
7340	200 mm	420 mm	80 mm	450	605

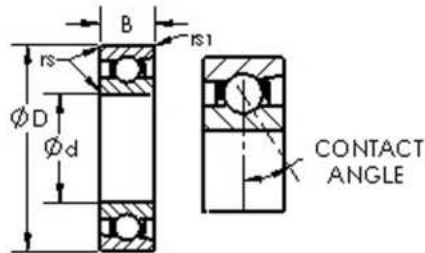

Product Number	Bore Dia (d)	Outer Dia (D)	Width (B)	Dynamic Load Rating (Cr) (kN)	Static Load Rating (Cor) (kN)
7905	25 mm	42 mm	9 mm	7.15	4.95
7906	30 mm	47 mm	9 mm	7.55	5.75
7907	35 mm	55 mm	10 mm	12	8.85
7908	40 mm	62 mm	12 mm	12.7	10.2
7909	45 mm	68 mm	12 mm	15.7	12.9
7910	50 mm	72 mm	12 mm	16.6	14.5
7911	55 mm	80 mm	13 mm	17.3	16.1
7912	60 mm	85 mm	13 mm	18.1	17.4
7913	65 mm	90 mm	13 mm	18.3	18
7914	70 mm	100 mm	16 mm	26.2	26.2
7915	75 mm	105 mm	16 mm	25.6	70.1
7916	80 mm	110 mm	16 mm	26.9	28
7917	85 mm	120 mm	18 mm	36	38
7918	90 mm	125 mm	18 mm	36	38
7919	95 mm	130 mm	18 mm	37	40.5
7920	100 mm	140 mm	20 mm	48	52.5
7921	105 mm	145 mm	20 mm	48.5	54.5

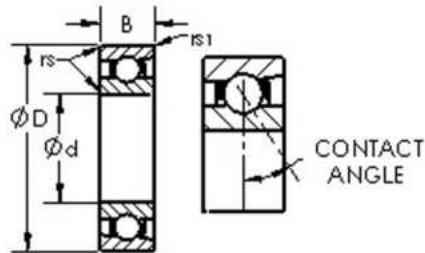

Product Number	Bore Dia (d)	Outer Dia (D)	Width (B)	Dynamic Load Rating (Cr) (kN)	Static Load Rating (Cor) (kN)
7922	110 mm	150 mm	20 mm	49.5	56
7924	120 mm	165 mm	22 mm	61	69.5
7926	130 mm	180 mm	24 mm	75	87.5
7928	140 mm	190 mm	24 mm	75.5	90
7930	150 mm	210 mm	28 mm	97.5	117
7932	160 mm	280 mm	28 mm	98.5	121
7934	170 mm	230 mm	28 mm	102	129
7936	180 mm	250 mm	33 mm	131	163
7938	190 mm	260 mm	33 mm	133	169
7940	200 mm	280 mm	38 mm	185	231
7944	220 mm	300 mm	38 mm	187	239
7948	240 mm	320 mm	38 mm	197	264
7952	260 mm	360 mm	46 mm	258	375
7956	280 mm	380 mm	46 mm	261	385
7960	300 mm	420 mm	56 mm	325	520

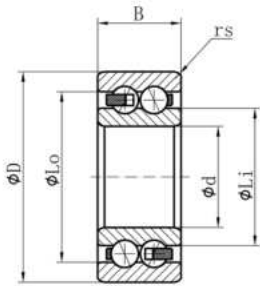

Open

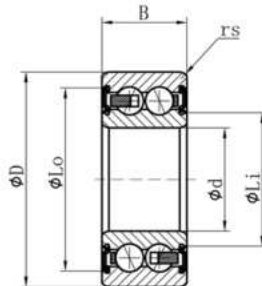

Sealed (RS)

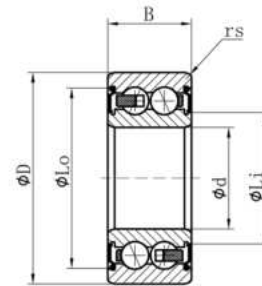

Shielded (ZZ)

Product Number	Bore Dia (d)	Outer Dia (D)	Width (B)	Dynamic Load Rating (Cr) (kN)	Static Load Rating (Cor) (kN)
5200	10 mm	30 mm	14.287 mm	7.15	3.9
5200zz	10 mm	30 mm	14.287 mm	7.15	3.9
5200-2RS	10 mm	30 mm	14.287 mm	7.15	3.9
5201	12 mm	32 mm	15.875 mm	10.6	5.85
5201zz	12 mm	32 mm	15.875 mm	10.6	5.85
5201-2RS	12 mm	32 mm	15.875 mm	10.6	5.85
5202	15 mm	35 mm	15.875 mm	11.7	6.95
5202zz	15 mm	35 mm	15.875 mm	11.7	6.95
5202-2RS	15 mm	35 mm	15.875 mm	11.7	6.95
5203	17 mm	40 mm	17.462 mm	14.8	9
5203zz	17 mm	40 mm	17.462 mm	14.8	9
5203-2RS	17 mm	40 mm	17.462 mm	14.8	9
5204	20 mm	47 mm	20.638 mm	19.5	12.2
5204zz	20 mm	47 mm	20.638 mm	19.5	12.2
5204-2RS	20 mm	47 mm	20.638 mm	19.5	12.2
5205	25 mm	52 mm	20.638 mm	21.2	14.6
5205zz	25 mm	52 mm	20.638 mm	21.2	14.6

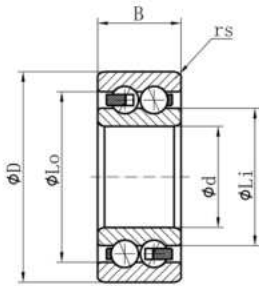

Open

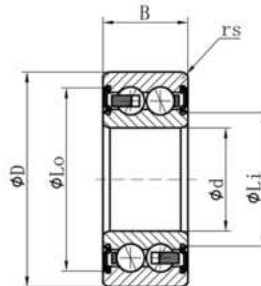

Sealed (RS)

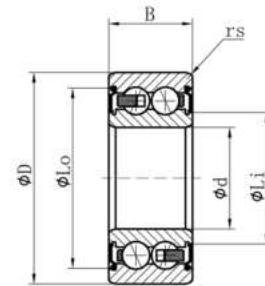

Shielded (ZZ)

Product Number	Bore Dia (d)	Outer Dia (D)	Width (B)	Dynamic Load Rating (Cr) (kN)	Static Load Rating (Cor) (kN)
5205-2RS	25 mm	52 mm	20.638 mm	21.2	14.6
5206	30 mm	62 mm	23.812 mm	29.6	21.2
5206zz	30 mm	62 mm	23.812 mm	29.6	21.2
5206-2RS	30 mm	62 mm	23.812 mm	29.6	21.2
5207	35 mm	72 mm	26.990 mm	37.7	27.5
5207zz	35 mm	72 mm	26.990 mm	37.7	27.5
5207-2RS	35 mm	72 mm	26.990 mm	37.7	27.5
5208	40 mm	80 mm	30.163 mm	44.9	34
5208zz	40 mm	80 mm	30.163 mm	44.9	34
5208-2RS	40 mm	80 mm	30.163 mm	44.9	34
5209	45 mm	85 mm	30.163 mm	48.8	39
5209zz	45 mm	85 mm	30.163 mm	48.8	39
5209-2RS	45 mm	85 mm	30.163 mm	48.8	39
5210	50 mm	90 mm	30.163 mm	48.8	39
5210zz	50 mm	90 mm	30.163 mm	48.8	39
5210-2RS	50 mm	90 mm	30.163 mm	48.8	39
5211	55 mm	100 mm	33.338 mm	57.2	47.5

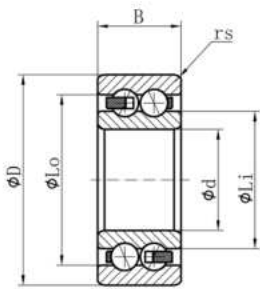

Open

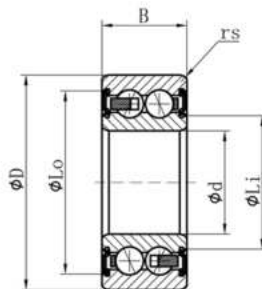

Sealed (RS)

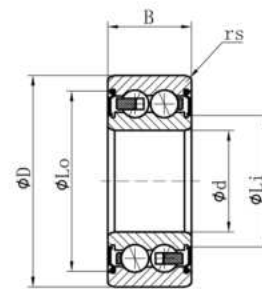

Shielded (ZZ)

Product Number	Bore Dia (d)	Outer Dia (D)	Width (B)	Dynamic Load Rating (Cr) (kN)	Static Load Rating (Cor) (kN)
5211zz	55 mm	100 mm	33.338 mm	57.2	47.5
5211-2RS	55 mm	100 mm	33.338 mm	57.2	47.5
5212	60 mm	110 mm	36.513 mm	70.2	58.5
5212zz	60 mm	110 mm	36.513 mm	70.2	58.5
5212-2RS	60 mm	110 mm	36.513 mm	70.2	58.5
5213	65 mm	120 mm	38.100 mm	80.6	73.5
5213zz	65 mm	120 mm	38.100 mm	80.6	73.5
5213-2RS	65 mm	120 mm	38.100 mm	80.6	73.5
5214	70 mm	125 mm	39.688 mm	88.4	80
5214zz	70 mm	125 mm	39.688 mm	88.4	80
5214-2RS	70 mm	125 mm	39.688 mm	88.4	80
5215	75 mm	130 mm	41.275 mm	95.6	88
5215zz	75 mm	130 mm	41.275 mm	95.6	88
5215-2RS	75 mm	130 mm	41.275 mm	95.6	88
5216	80 mm	140 mm	44.450 mm	106	95
5216zz	80 mm	140 mm	44.450 mm	106	95
5216-2RS	80 mm	140 mm	44.450 mm	106	95

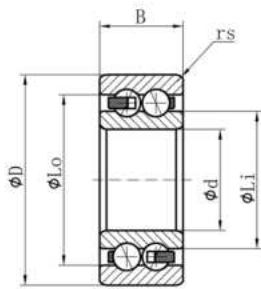

Open

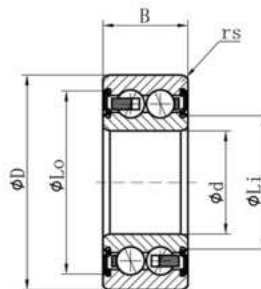

Sealed (RS)

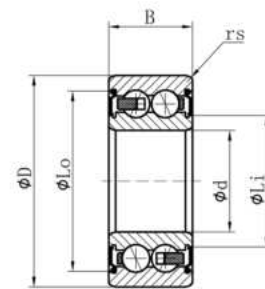

Shielded (ZZ)

Product Number	Bore Dia (d)	Outer Dia (D)	Width (B)	Dynamic Load Rating (Cr) (kN)	Static Load Rating (Cor) (kN)
5217	85 mm	150 mm	49.213 mm	124	110
5217zz	85 mm	150 mm	49.213 mm	124	110
5217-2RS	85 mm	150 mm	49.213 mm	124	110
5218	90 mm	160 mm	52.388 mm	130	120
5218zz	90 mm	160 mm	52.388 mm	130	120
5218-2RS	90 mm	160 mm	52.388 mm	130	120
5219	95 mm	170 mm	55.563 mm	165	153
5219zz	95 mm	170 mm	55.563 mm	165	153
5219-2RS	95 mm	170 mm	55.563 mm	165	153
5220	100 mm	180 mm	60.325 mm	186	173
5220zz	100 mm	180 mm	60.325 mm	186	173
5220-2RS	100 mm	180 mm	60.325 mm	186	173

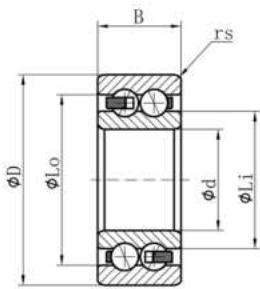

Open

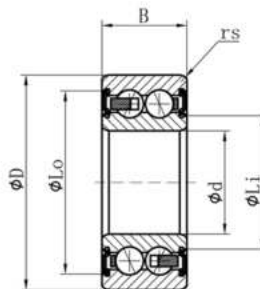

Sealed (RS)

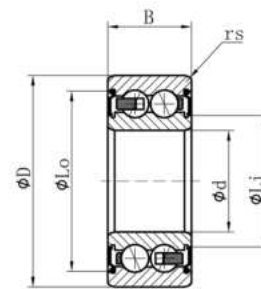

Shielded (ZZ)

Product Number	Bore Dia (d)	Outer Dia (D)	Width (B)	Dynamic Load Rating (Cr) (kN)	Static Load Rating (Cor) (kN)
5304	20 mm	52 mm	22.225 mm	22.5	14.6
5304ZZ	20 mm	52 mm	22.225 mm	22.5	14.6
5304-2RS	20 mm	52 mm	22.225 mm	22.5	14.6
5305	25 mm	62 mm	25.400 mm	30.7	20.4
5305ZZ	25 mm	62 mm	25.400 mm	30.7	20.4
5305-2RS	25 mm	62 mm	25.400 mm	30.7	20.4
5306	30 mm	72 mm	30.160 mm	41.6	29
5306ZZ	30 mm	72 mm	30.160 mm	41.6	29
5306-2RS	30 mm	72 mm	30.160 mm	41.6	29
5307	35 mm	80 mm	34.930 mm	49.4	34.5
5307ZZ	35 mm	80 mm	34.930 mm	49.4	34.5
5307-2RS	35 mm	80 mm	34.930 mm	49.4	34.5
5308	40 mm	90mm	36.513 mm	60.5	43
5308ZZ	40 mm	90 mm	36.513 mm	60.5	43
5308-2RS	40 mm	90 mm	36.513 mm	60.5	43
5309	45 mm	100 mm	39.688 mm	72.8	53
5309ZZ	45 mm	100 mm	39.688 mm	72.8	53

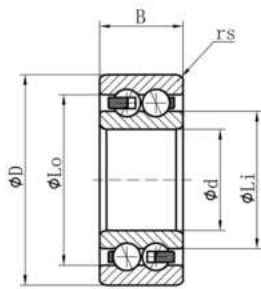

Open

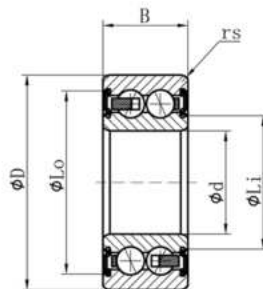

Sealed (RS)

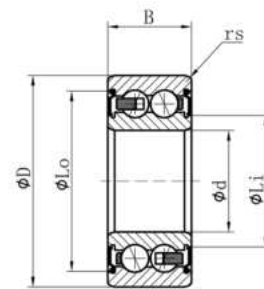

Shielded (ZZ)

Product Number	Bore Dia (d)	Outer Dia (D)	Width (B)	Dynamic Load Rating (Cr) (kN)	Static Load Rating (Cor) (kN)
5309-2RS	45 mm	100 mm	39.688 mm	72.8	53
5310	50 mm	110 mm	45.450 mm	85.2	64
5310ZZ	50 mm	110 mm	45.450 mm	85.2	64
5310-2RS	50 mm	110 mm	45.450 mm	85.2	64
5311	55 mm	120 mm	49.213 mm	106	81.5
5311ZZ	55 mm	120 mm	49.213 mm	106	81.5
5311-2RS	55 mm	120 mm	49.213 mm	106	81.5
5312	60 mm	130 mm	53.975 mm	121	95
5312ZZ	60 mm	130 mm	53.975 mm	121	95
5312-2RS	60 mm	130 mm	53.975 mm	121	95
5313	65 mm	140 mm	58.738 mm	138	108
5313ZZ	65 mm	140 mm	58.738 mm	138	108
5313-2RS	65 mm	140 mm	58.738 mm	138	108
5314	70 mm	150 mm	63.500 mm	153	125
5314ZZ	70 mm	150 mm	63.500 mm	153	125
5314-2RS	70 mm	150 mm	63.500 mm	153	125
5315	75 mm	160 mm	68.263 mm	168	140

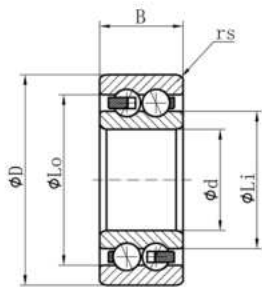

Open

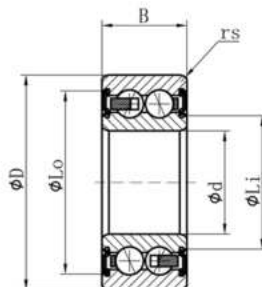

Sealed (RS)

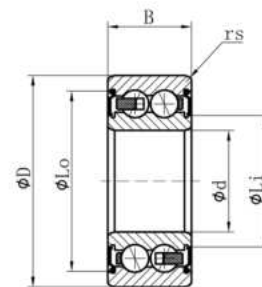

Shielded (ZZ)

Product Number	Bore Dia (d)	Outer Dia (D)	Width (B)	Dynamic Load Rating (Cr) (kN)	Static Load Rating (Cor) (kN)
5315ZZ	75 mm	160 mm	68.263 mm	168	140
5315-2RS	75 mm	160 mm	68.263 mm	168	140
5316	80 mm	170 mm	68.623 mm	182	156
5316ZZ	80 mm	170 mm	68.263 mm	182	156
5316-2RS	80 mm	170 mm	68.263 mm	182	156
5317	85 mm	180 mm	73.025 mm	195	176
5317ZZ	85 mm	180 mm	73.025 mm	195	176
5317-2RS	85 mm	180 mm	73.025 mm	195	176
5318	90 mm	190 mm	73.025 mm	212	196
5318ZZ	90 mm	190 mm	73.025 mm	212	196
5318-2RS	90 mm	190 mm	73.025 mm	212	196

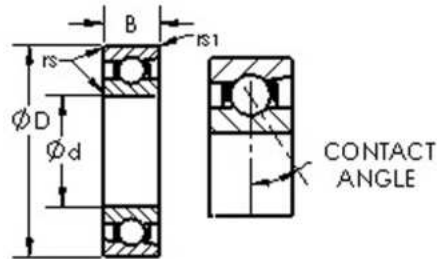

Product Number	Contact Angle (θ)(deg)	Bore Dia (d)	Outer Dia (D)	Width (B)	Dynamic Load Rating (Cr) (kN)	Static Load Rating (Cor) (kN)
H71900C	15	10 mm	22 mm	6 mm	2.1	0.9
H71900C/HQ1	15	10 mm	22 mm	6 mm	2.1	0.9
H71900AC	25	10 mm	22 mm	6 mm	2	0.9
H71900AC/HQ1	25	10 mm	22 mm	6 mm	2	0.9
H7000C/HQ1	15	10 mm	26 mm	8 mm	3.4	1.5
H7000AC	25	10 mm	26 mm	8 mm	3.3	1.4
H7000AC/HQ1	25	10 mm	26 mm	8 mm	3.3	1.4
H7000C	15	10 mm	26 mm	8 mm	3.4	1.5
H71901C	15	12 mm	24 mm	6 mm	2.2	1.1
H71901C/HQ1	15	12 mm	24 mm	6 mm	2.2	1.1
H71901AC	25	12 mm	24 mm	6 mm	2.1	1.1
H71901AC/HQ1	25	12 mm	24 mm	6 mm	2.1	1.1
H7001C	15	12 mm	28 mm	8 mm	3.8	1.7
H7001C/HQ1	15	12 mm	28 mm	8 mm	3.8	1.7
H7001AC	25	12 mm	28 mm	8 mm	3.6	1.6
H7001AC/HQ1	25	12 mm	28 mm	8 mm	3.6	1.6
H71902C	15	15 mm	28 mm	7 mm	3.2	1.7

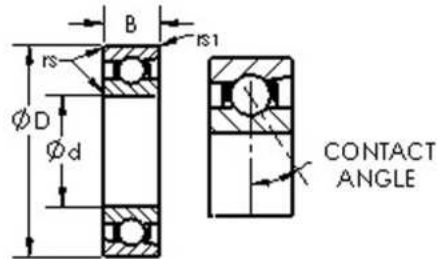

Product Number	Contact Angle (θ)(deg)	Bore Dia (d)	Outer Dia (D)	Width (B)	Dynamic Load Rating (Cr) (kN)	Static Load Rating (Cor) (kN)
H71902C/HQ1	15	15 mm	28 mm	7 mm	3.2	1.7
H71902AC	25	15 mm	28 mm	7 mm	3.1	1.6
H71902AC/HQ1	25	15 mm	28 mm	7 mm	3.1	1.6
H7002C	15	15 mm	32 mm	9 mm	4.4	2.2
H7002C/HQ1	15	15 mm	32 mm	9 mm	4.4	2.2
H7002AC	25	15 mm	32 mm	9 mm	4.2	2.1
H7002AC/HQ1	25	15 mm	32 mm	9 mm	4.2	2.1
H71903C	15	17 mm	30 mm	7 mm	3.3	1.8
H71903C/HQ1	15	17 mm	30 mm	7 mm	3.3	1.8
H71903AC	25	17 mm	30 mm	7 mm	3.2	1.7
H71903AC/HQ1	25	17 mm	30 mm	7 mm	3.2	1.7
H7003C	25	17 mm	35 mm	10 mm	5	2.4
I H7003C/HQ1	15	17 mm	35 mm	10 mm	5.2	2.5
H7003AC	25	17 mm	35 mm	10 mm	5	2.4
I H7003AC/HQ1	25	17 mm	35 mm	10 mm	5	2.4
H71904C	15	20 mm	37 mm	9 mm	5	2.9
H71904C/HQ1	15	20 mm	37 mm	9 mm	5	2.9

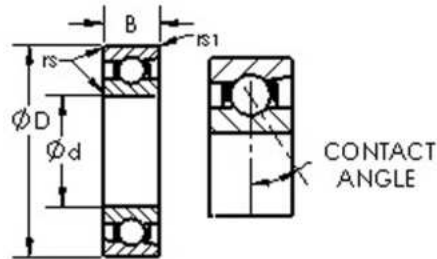

Product Number	Contact Angle (θ)(deg)	Bore Dia (d)	Outer Dia (D)	Width (B)	Dynamic Load Rating (Cr) (kN)	Static Load Rating (Cor) (kN)
H71904AC	25	20 mm	37 mm	9 mm	4.8	2.7
H71904AC/HQ1	25	20 mm	37 mm	9 mm	4.8	2.7
H7004C	15	20 mm	42 mm	12 mm	7.4	3.9
H7004C/HQ1	15	20 mm	42 mm	12 mm	7.4	3.9
H7004AC	25	20 mm	42 mm	12 mm	7	3.8
H7004AC/HQ1	25	20 mm	42 mm	12 mm	7	3.8
H71905C	15	25 mm	42 mm	9 mm	5.2	3.4
H71905/HQ1C	15	25 mm	42 mm	9 mm	5.2	3.4
H71905AC	25	25 mm	42 mm	9 mm	4.9	3.3
H71905/HQ1AC	25	25 mm	42 mm	9 mm	4.9	3.3
H7005C	15	25 mm	47 mm	12 mm	8.4	4.8
H7005C/HQ1	15	25 mm	47 mm	12 mm	8.4	4.8
H7005AC	25	25 mm	47 mm	12 mm	8	4.6
H7005AC/HQ1	25	25 mm	47 mm	12 mm	8	4.6
H71906C	15	30 mm	47 mm	9 mm	5.8	3.8
H71906C/HQ1	15	30 mm	47 mm	9 mm	5.8	3.8
H71906AC	25	30 mm	47 mm	9 mm	5.4	3.6

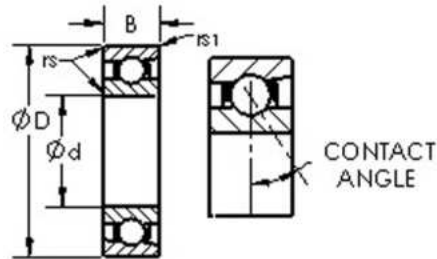

Product Number	Contact Angle (θ)(deg)	Bore Dia (d)	Outer Dia (D)	Width (B)	Dynamic Load Rating (Cr) (kN)	Static Load Rating (Cor) (kN)
H71906AC/HQ1	25	30 mm	47 mm	9 mm	5.4	3.6
H7006C	15	30 mm	55 mm	13 mm	9.5	6.2
H7006C/HQ1	15	30 mm	55 mm	13 mm	9.5	6.2
H7006AC	25	30 mm	55 mm	13 mm	9	5.9
H7006AC/HQ1	25	30 mm	55 mm	13 mm	9	5.9
H71907C	15	35 mm	55 mm	10 mm	7.7	5.4
H71907C/HQ1	15	35 mm	55 mm	10 mm	7.7	5.4
H71907AC	25	35 mm	55 mm	10 mm	7.4	5.1
H71907AC/HQ1	25	35 mm	55 mm	10 mm	7.4	5.1
H7007C	15	35 mm	62 mm	14 mm	11.2	7.9
H7007C/HQ1	15	35 mm	62 mm	14 mm	11.2	7.9
H7007AC	25	35 mm	62 mm	14 mm	10.7	7.5
H7007AC/HQ1	25	35 mm	62 mm	14 mm	10.7	7.5
H71908C	15	40 mm	62 mm	12 mm	9.8	7
H71908C/HQ1	15	40 mm	62 mm	12 mm	9.8	7
H71908AC	25	40 mm	62 mm	12 mm	9.3	6.6
H71908AC/HQ1	25	40 mm	62 mm	12 mm	9.3	6.6

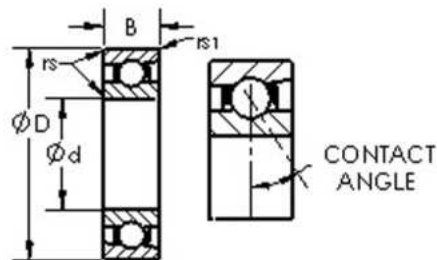

Product Number	Contact Angle (θ)(deg)	Bore Dia (d)	Outer Dia (D)	Width (B)	Dynamic Load Rating (Cr) (kN)	Static Load Rating (Cor) (kN)
H7008C	15	40 mm	68 mm	15 mm	12.5	9.1
H7008C/HQ1	15	40 mm	68 mm	15 mm	12.5	9.1
H7008AC	25	40 mm	68 mm	15 mm	11.1	8.6
H7008AC/HQ1	25	40 mm	68 mm	15 mm	11.1	8.6
H71909C	15	45 mm	68 mm	12 mm	10.3	7.7
H71909C/HQ1	15	45 mm	68 mm	12 mm	10.3	7.7
H71909AC	25	45 mm	68 mm	12 mm	9.7	7.3
H71909AC/HQ1	25	45 mm	68 mm	12 mm	9.7	7.3
H7009C	15	45 mm	75 mm	16 mm	13.1	10.2
H70091HQ1C	15	45 mm	75 mm	16 mm	13.1	10.2
H7009AC	25	45 mm	75 mm	16 mm	12.5	9.7
H70091HQ1AC	25	45 mm	75 mm	16 mm	12.5	9.7
H71910C	15	50 mm	72 mm	12 mm	13.2	10
H71910C/HQ1	15	50 mm	72 mm	12 mm	13.2	10
H71910AC	25	50 mm	72 mm	12 mm	12.5	9.5
H71910AC/HQ1	25	50 mm	72 mm	12 mm	12.5	9.5
H7010C	15	50 mm	80 mm	16 mm	15.4	12

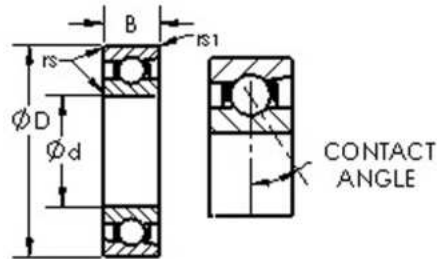

Product Number	Contact Angle (θ)(deg)	Bore Dia (d)	Outer Dia (D)	Width (B)	Dynamic Load Rating (Cr) (kN)	Static Load Rating (Cor) (kN)
H7010C/HQ1	15	50 mm	80 mm	16 mm	15.4	12
H7010AC	25	50 mm	80 mm	16 mm	14.7	11.4
H7010AC/HQ1	25	50 mm	80 mm	16 mm	14.7	11.4
H71911C	15	55 mm	80 mm	13 mm	16	12.6
H71911C/HQ1	15	55 mm	80 mm	13 mm	16	12.6
H71911AC	25	55 mm	80 mm	13 mm	15	11.9
H71911AC/HQ1	25	55 mm	80 mm	13 mm	15	11.9
H7011C	15	55 mm	90 mm	18 mm	17	14.5
H7011C/HQ1	15	55 mm	90 mm	18 mm	17	14.5
H7011AC	25	55 mm	90 mm	18 mm	16	13.7
H7011AC/HQ1	25	55 mm	90 mm	18 mm	16	13.7
H71912C	15	60 mm	85 mm	13 mm	16.6	13.8
H71912C/HQ1	15	60 mm	85 mm	13 mm	16.6	13.8
H71912AC	25	60 mm	85 mm	13 mm	15.7	13.1
H71912AC/HQ1	25	60 mm	85 mm	13 mm	15.7	13.1
H7012C	15	60 mm	95 mm	18 mm	17	15.3
H7012C/HQ1	15	60 mm	95 mm	18 mm	17	15.3

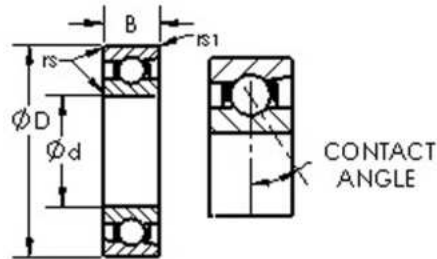

Product Number	Contact Angle (θ)(deg)	Bore Dia (d)	Outer Dia (D)	Width (B)	Dynamic Load Rating (Cr) (kN)	Static Load Rating (Cor) (kN)
H7012AC	25	60 mm	95 mm	18 mm	16.2	14.4
H7012AC/HQ1	25	60 mm	95 mm	18 mm	16.2	14.4
H71913C	15	65 mm	90 mm	13 mm	16.8	14.5
H71913C/HQ1	15	65 mm	90 mm	13 mm	16.8	14.5
H71913AC	25	65 mm	90 mm	13 mm	16	13.7
H71913AC/HQ1	25	65 mm	90 mm	13 mm	16	13.7
H7013C	15	65 mm	100 mm	18 mm	20.2	18.6
H7013C/HQ1	15	65 mm	100 mm	18 mm	20.2	18.6
H7013AC	25	65 mm	100 mm	18 mm	19	17.6
H7013AC/HQ1	25	65 mm	100 mm	18 mm	19	17.6
H71914C	15	70 mm	100 mm	16 mm	20.9	17.8
H71914C/HQ1	15	70 mm	100 mm	16 mm	20.9	17.8
H71914AC	25	70 mm	100 mm	16 mm	19.7	16.9
H71914AC/HQ1	25	70 mm	100 mm	16 mm	19.7	16.9
H7014C	15	70 mm	110 mm	20 mm	24.1	21.4
H7014C/HQ1	15	70 mm	110 mm	20 mm	24.1	21.4
H7014AC	25	70 mm	110 mm	20 mm	22.6	20.1

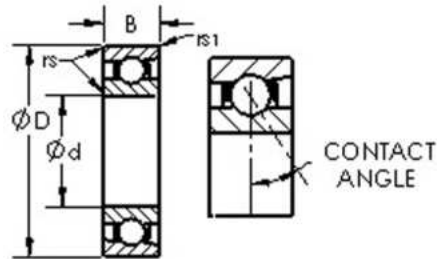

Product Number	Contact Angle (θ)(deg)	Bore Dia (d)	Outer Dia (D)	Width (B)	Dynamic Load Rating (Cr) (kN)	Static Load Rating (Cor) (kN)
H7014AC/HQ1	25	70 mm	110 mm	20 mm	22.6	20.1
H71915C	15	75 mm	105 mm	16 mm	21.7	19.3
H71915C/HQ1	15	75 mm	105 mm	16 mm	21.7	19.3
H71915AC	25	75 mm	105 mm	16 mm	20.5	18.2
H71915AC/HQ1	25	75 mm	105 mm	16 mm	20.5	18.2
H7015C	15	75 mm	115 mm	20 mm	26.2	25.5
H7015C/HQ1	15	75 mm	115 mm	20 mm	26.2	25.5
H7015AC	25	75 mm	115 mm	20 mm	24.7	24.2
H7015AC/HQ1	25	75 mm	115 mm	20 mm	24.7	24.2
H71916C	15	80 mm	110 mm	16 mm	22.4	20.8
H71916C/HQ1	15	80 mm	110 mm	16 mm	22.4	20.8
H71916AC	25	80 mm	110 mm	16 mm	21.2	19.6
H71916AC/HQ1	25	80 mm	110 mm	16 mm	21.2	19.6
H7016C	15	80 mm	125 mm	22 mm	34.2	32.7
H7016C/HQ1	15	80 mm	125 mm	22 mm	34.2	32.7
H7016AC	25	80 mm	125 mm	22 mm	32.3	31
H7016AC/HQ1	25	80 mm	125 mm	22 mm	32.3	31

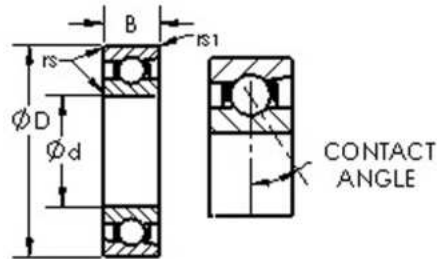

Product Number	Contact Angle (θ)(deg)	Bore Dia (d)	Outer Dia (D)	Width (B)	Dynamic Load Rating (Cr) (kN)	Static Load Rating (Cor) (kN)
H71917C	15	85 mm	120 mm	18 mm	26.1	24.2
H71917C/HQ1	15	85 mm	120 mm	18 mm	26.1	24.2
H71917AC	25	85 mm	120 mm	18 mm	24.7	22.9
H7017C	15	85 mm	130 mm	22 mm	35	35.2
H71917AC/HQ1	25	85 mm	120 mm	18 mm	24.7	22.9
H7017C/HQ1	15	85 mm	130 mm	22 mm	35	35.2
H7017AC	25	85 mm	130 mm	22 mm	33	33.4
H7017AC/HQ1	25	85 mm	130 mm	22 mm	33	33.4
H71918C	15	90 mm	125 mm	18 mm	27	26
H71918C/HQ1	15	90 mm	125 mm	18 mm	27	26
H71918AC	25	90 mm	125 mm	18 mm	25.5	24.6
H71918AC/HQ1	25	90 mm	125 mm	18 mm	25.5	24.6
H7018C	15	90 mm	140 mm	24 mm	36.4	38.1
H7018C/HQ1	15	90 mm	140 mm	24 mm	36.4	38.1
H7018AC	25	90 mm	140 mm	24 mm	34.3	36.1
H7018AC/HQ1	25	90 mm	140 mm	24 mm	34.3	36.1
H71919C	15	95 mm	130 mm	18 mm	27.3	26

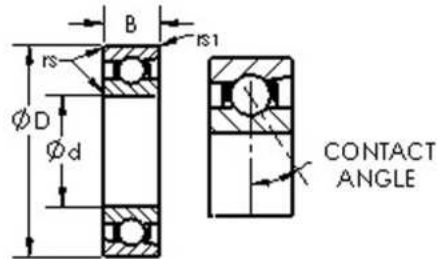

Product Number	Contact Angle (θ)(deg)	Bore Dia (d)	Outer Dia (D)	Width (B)	Dynamic Load Rating (Cr) (kN)	Static Load Rating (Cor) (kN)
H71919C/HQ1	15	95 mm	130 mm	18 mm	27.3	26
H71919AC	25	95 mm	130 mm	18 mm	25.8	25.4
H71919AC/HQ1	25	95 mm	130 mm	18 mm	25.8	25.4
H7019C	15	95 mm	145 mm	24 mm	44.4	45.2
H7019C/HQ1	15	95 mm	145 mm	24 mm	44.4	45.2
H7019AC	25	95 mm	145 mm	24 mm	41.9	42.9
H7019AC/HQ1	25	95 mm	145 mm	24 mm	41.9	42.9
H71920C	15	100 mm	140 mm	20 mm	40.1	37.6
H71920C/HQ1	15	100 mm	140 mm	20 mm	40.1	37.6
H71920AC	25	100 mm	140 mm	20 mm	37.9	35.5
H71920AC/HQ1	25	100 mm	140 mm	20 mm	37.9	35.5
H7020C	15	100 mm	150 mm	24 mm	45.4	48.1
H7020C/HQ1	15	100 mm	150 mm	24 mm	45.4	48.1
H7020AC	25	100 mm	150 mm	24 mm	42.7	44.7
H7020AC/HQ1	25	100 mm	150 mm	24 mm	42.7	44.7
H71921C	15	105 mm	145 mm	20 mm	40.7	39.1
H71921C/HQ1	15	105 mm	145 mm	20 mm	40.7	39.1

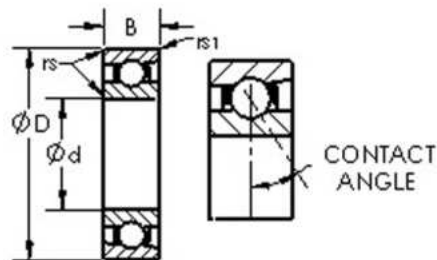

Product Number	Contact Angle (θ)(deg)	Bore Dia (d)	Outer Dia (D)	Width (B)	Dynamic Load Rating (Cr) (kN)	Static Load Rating (Cor) (kN)
H71921AC	25	105 mm	145 mm	20 mm	38.4	36.9
H71921AC/HQ1	25	105 mm	145 mm	20 mm	34.8	36.9
H7021C	15	105 mm	160 mm	26 mm	46.1	49.2
H7021C/HQ1	15	105 mm	160 mm	26 mm	46.1	49.2
H7021AC	25	105 mm	160 mm	26 mm	43.3	46.6
H7021AC/HQ1	25	105 mm	160 mm	26 mm	43.3	46.6
H71922C	15	110 mm	150 mm	20 mm	41.3	40.5
H71922C/HQ1	15	110 mm	150 mm	20 mm	41.3	40.5
H71922AC	25	110 mm	150 mm	20 mm	39	38.3
H71922AC/HQ1	25	110 mm	150 mm	20 mm	39	38.3
H7022C/HQ1	15	110 mm	170 mm	28 mm	47.9	53.9
H7022C	15	110 mm	170 mm	28 mm	47.9	53.9
H7022AC	25	110 mm	170 mm	28 mm	45.1	51.1
H7022AC/HQ1	25	110 mm	170 mm	28 mm	45.1	51.1
H71924C	15	120 mm	165 mm	22 mm	43.1	44.9
H71924C/HQ1	15	120 mm	165 mm	22 mm	43.1	44.9
H71924AC	25	120 mm	165 mm	22 mm	40.7	42.4

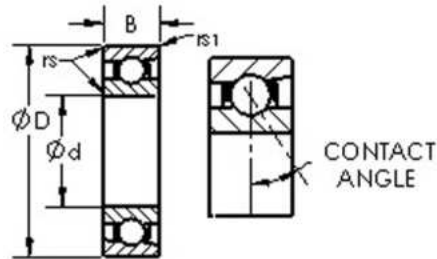

Product Number	Contact Angle (θ)(deg)	Bore Dia (d)	Outer Dia (D)	Width (B)	Dynamic Load Rating (Cr) (kN)	Static Load Rating (Cor) (kN)
H71924AC/HQ1	25	120 mm	165 mm	22 mm	40.7	42.4
H7024C	15	120 mm	180 mm	28 mm	58.3	64.9
H7024C/HQ1	15	120 mm	180 mm	28 mm	58.3	64.9
H7024AC	25	120 mm	180 mm	28 mm	54.8	61.5
H7024AC/HQ1	25	120 mm	180 mm	28 mm	54.8	61.5
H71926C	15	130 mm	180 mm	24 mm	53.1	56.6
H71926C/HQ1	15	130 mm	180 mm	24 mm	53.1	56.6
H71926AC	25	130 mm	180 mm	24 mm	50.1	53.4
H71926AC/HQ1	25	130 mm	180 mm	24 mm	50.1	53.4
H7026C	15	130 mm	200 mm	33 mm	58.6	66.8
H7026C/HQ1	15	130 mm	200 mm	33 mm	58.6	66.8
H7026AC	25	130 mm	200 mm	33 mm	55.1	63.2
H7026AC/HQ1	25	130 mm	200 mm	33 mm	55.1	63.2
H71928C	15	140 mm	190 mm	24 mm	53.7	59.1
H71928C/HQ1	15	140 mm	190 mm	24 mm	53.7	59.1
H71928AC	25	140 mm	190 mm	24 mm	50.7	55.8
H71928AC/HQ1	25	140 mm	190 mm	24 mm	50.7	55.8

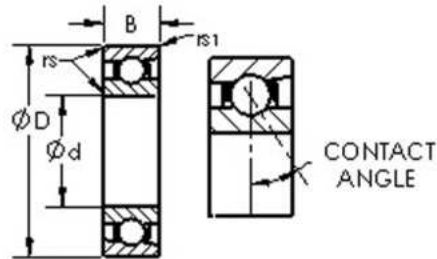

Product Number	Contact Angle (θ)(deg)	Bore Dia (d)	Outer Dia (D)	Width (B)	Dynamic Load Rating (Cr) (kN)	Static Load Rating (Cor) (kN)
H7028C	15	140 mm	210 mm	33 mm	60.7	72.5
H7028C/HQ1	15	140 mm	210 mm	33 mm	60.7	72.5
H7028AC	25	140 mm	210 mm	33 mm	57.1	68.7
H7028AC/HQ1	25	140 mm	210 mm	33 mm	57.1	68.7
H71930C	15	150 mm	210 mm	28 mm	65.2	72.8
H71930C/HQ1	15	150 mm	210 mm	28 mm	65.2	72.8
H71930AC	25	150 mm	210 mm	28 mm	61.5	68.7
H71930AC/HQ1	25	150 mm	210 mm	28 mm	61.5	68.7
H7030C	15	150 mm	225 mm	35 mm	74.9	88.5
H7030C/HQ1	15	150 mm	225 mm	35 mm	74.9	88.5
H7030AC	25	150 mm	225 mm	35 mm	70.5	83.8
H7030AC/HQ1	25	150 mm	225 mm	35 mm	70.5	83.8
H71932C	15	160 mm	220 mm	28 mm	66	75.8
H71932C/HQ1	15	160 mm	220 mm	28 mm	66	75.8
H71932AC	25	160 mm	220 mm	28 mm	62.3	71.6
H71932AC/HQ1	25	160 mm	220 mm	28 mm	62.3	71.6
H7032C	15	160 mm	240 mm	38 mm	76.2	94.5

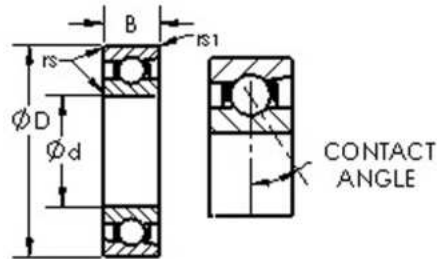

Product Number	Contact Angle (θ)(deg)	Bore Dia (d)	Outer Dia (D)	Width (B)	Dynamic Load Rating (Cr) (kN)	Static Load Rating (Cor) (kN)
H7032C/HQ1	15	160 mm	240 mm	38 mm	76.2	94.5
H7032AC	25	160 mm	240 mm	38 mm	71.6	89.5
H7032AC/HQ1	25	160 mm	240 mm	38 mm	71.6	89.5
H71934C	15	170 mm	230 mm	28 mm	66.7	78.7
H71934C/HQ1	15	170 mm	230 mm	28 mm	66.7	78.7
H71934AC	25	170 mm	230 mm	28 mm	63	74.3
H71934AC/HQ1	25	170 mm	230 mm	28 mm	63	74.3
H7034C	15	170 mm	260 mm	42 mm	78.1	100.6
H7034C/HQ1	15	170 mm	260 mm	42 mm	78.1	100.6
H7034AC	25	170 mm	260 mm	42 mm	73.4	95.2
H7034AC/HQ1	25	170 mm	260 mm	42 mm	73.4	95.2
H71936C	15	180 mm	250 mm	33 mm	79.6	95
H71936C/HQ1	15	180 mm	250 mm	33 mm	79.6	95
H71936AC	25	180 mm	250 mm	33 mm	75.2	89.7
H71936AC/HQ1	25	180 mm	250 mm	33 mm	75.2	89.7
H7036AC	25	180 mm	280 mm	46 mm	75	101
H7036C	15	180 mm	280 mm	46 mm	79.8	106.7

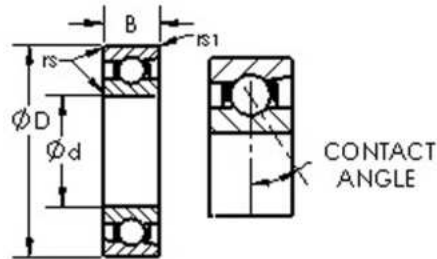

Product Number	Contact Angle (θ)(deg)	Bore Dia (d)	Outer Dia (D)	Width (B)	Dynamic Load Rating (Cr) (kN)	Static Load Rating (Cor) (kN)
H7036C/HQ1	15	180 mm	280 mm	46 mm	79.8	106.7
H7036AC/HQ1	25	180 mm	280 mm	46 mm	75	101
H71938C	15	190 mm	260 mm	33 mm	80.6	98.6
H71938C/HQ1	15	190 mm	260 mm	33 mm	80.6	98.6
H71938AC	25	190 mm	260 mm	33 mm	76.1	93.1
H71938AC/HQ1	25	190 mm	260 mm	33 mm	76.1	93.1
H7038C	15	190 mm	290 mm	46 mm	95.3	124.6
H7038C/HQ1	15	190 mm	290 mm	46 mm	95.3	124.6
H7038AC	25	190 mm	290 mm	46 mm	89.7	117.9
H7038AC/HQ1	25	190 mm	290 mm	46 mm	89.7	117.9
H71940C	15	200 mm	280 mm	38 mm	82.8	105.4
H71940C/HQ1	15	200 mm	280 mm	38 mm	82.8	105.4
H71940AC	25	200 mm	280 mm	38 mm	78.2	99.5
H71940AC/HQ1	25	200 mm	280 mm	38 mm	78.2	99.5
H7040C	15	200 mm	310 mm	51 mm	96.5	132
H7040C/HQ1	15	200 mm	310 mm	51 mm	96.5	132
H7040AC	25	200 mm	310 mm	51 mm	90.8	124.9

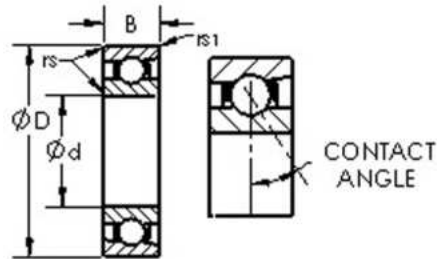

Product Number	Contact Angle (θ)(deg)	Bore Dia (d)	Outer Dia (D)	Width (B)	Dynamic Load Rating (Cr) (kN)	Static Load Rating (Cor) (kN)
H7040AC/HQ1	25	200 mm	310 mm	51 mm	90.8	124.9
H71944C	15	220 mm	300 mm	38 mm	96.9	125.4
H71944C/HQ1	15	220 mm	300 mm	38 mm	96.9	125.4
H71944AC	25	220 mm	300 mm	38 mm	91.5	118.4
H71944AC/HQ1	25	220 mm	300 mm	38 mm	91.5	118.4
H7044C	15	220 mm	340 mm	56 mm	113.9	156.5
H7044C/HQ1	15	220 mm	340 mm	56 mm	113.9	156.5
H7044AC	25	220 mm	340 mm	56 mm	107.2	148.1
H7044AC/HQ1	25	220 mm	340 mm	56 mm	107.2	148.1

Contact Us

Shanghai Lily Bearing Manufacturing Co.,Ltd.

Address:

Tairi Industry park No.900, Jinhui Town, Fengxian district, Shanghai, China

Sales Office:

Room 713, Zhonghuan Science & Technology Park, No. 485 Xingmei Road,
Minhang District, Shanghai, China

Tel: 0086-21-54331360

Fax: 0086-21-51010235

Email: lilybearing@lily-bearing.com

Website: www.lily-bearing.com